

GROUP 51

EXTERIOR

CONTENTS

FRONT BUMPER ASSEMBLY .	51-3	GARNISHES AND MOLDINGS . . .	51-11
SPECIAL TOOL	51-3	REMOVAL AND INSTALLATION	51-11
FRONT BUMPER ASSEMBLY . . .	51-4	AERO PARTS	51-15
REMOVAL AND INSTALLATION	51-4	REMOVAL AND INSTALLATION	51-15
DISASSEMBLY AND ASSEMBLY	51-5	WINDSHIELD WIPER AND	
REAR BUMPER ASSEMBLY . .	51-7	WASHER*	51-16
SPECIAL TOOL	51-7	GENERAL INFORMATION	51-16
REAR BUMPER ASSEMBLY	51-7	WINDSHIELD WIPER AND WASHER	
REMOVAL AND INSTALLATION	51-7	DIAGNOSIS	51-16
DISASSEMBLY AND REASSEMBLY . .	51-9	WINDSHIELD WIPER AND	
GARNISHES AND MOLDINGS .	51-10	WASHER	51-17
SPECIAL TOOLS	51-10	REMOVAL AND INSTALLATION	51-17
		INSPECTION	51-20

Continued on next page

WARNINGS REGARDING SERVICING OF SUPPLEMENTAL RESTRAINT SYSTEM (SRS) EQUIPPED VEHICLES

WARNING

- *Improper service or maintenance of any component of the SRS, or any SRS-related component, can lead to personal injury or death to service personnel (from inadvertent firing of the air bag) or to the driver and passenger (from rendering the SRS inoperative).*
- *Service or maintenance of any SRS component or SRS-related component must be performed only at an authorized MITSUBISHI dealer.*
- *MITSUBISHI dealer personnel must thoroughly review this manual, and especially its GROUP 52B - Supplemental Restraint System (SRS) before beginning any service or maintenance of any component of the SRS or any SRS-related component.*

NOTE

The SRS includes the following components: SRS air bag control unit, SRS warning light, front impact sensors, air bag module, clock spring, and interconnecting wiring. Other SRS-related components (that may have to be removed/installed in connection with SRS service or maintenance) are indicated in the table of contents by an asterisk (*).

REAR WIPER AND WASHER	51-21	DOOR MIRROR	51-27
GENERAL INFORMATION	51-21		
EXTERIOR DIAGNOSIS	51-21	SPECIAL TOOL	51-27
REAR WIPER	51-22	DOOR MIRROR	51-28
REMOVAL AND INSTALLATION	51-22	REMOVAL AND INSTALLATION	51-28
INSPECTION	51-24	INSPECTION	51-29
MARK	51-25	SPECIFICATIONS	51-30
SPECIAL TOOL	51-25	FASTENER TIGHTENING	
MARK	51-25	SPECIFICATIONS	51-30
REMOVAL AND INSTALLATION	51-25	SERVICE SPECIFICATIONS	51-30
		SEALANT AND ADHESIVE	51-30

FRONT BUMPER ASSEMBLY

SPECIAL TOOL

M1511000600542

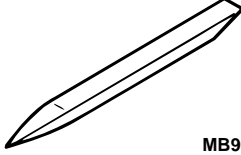
TOOL	TOOL NUMBER AND NAME	SUPERSESSION	APPLICATION
 MB990784	MB990784 Ornament remover	General service tool	Removal of clip

FRONT BUMPER ASSEMBLY
REMOVAL AND INSTALLATION

M1511001400187

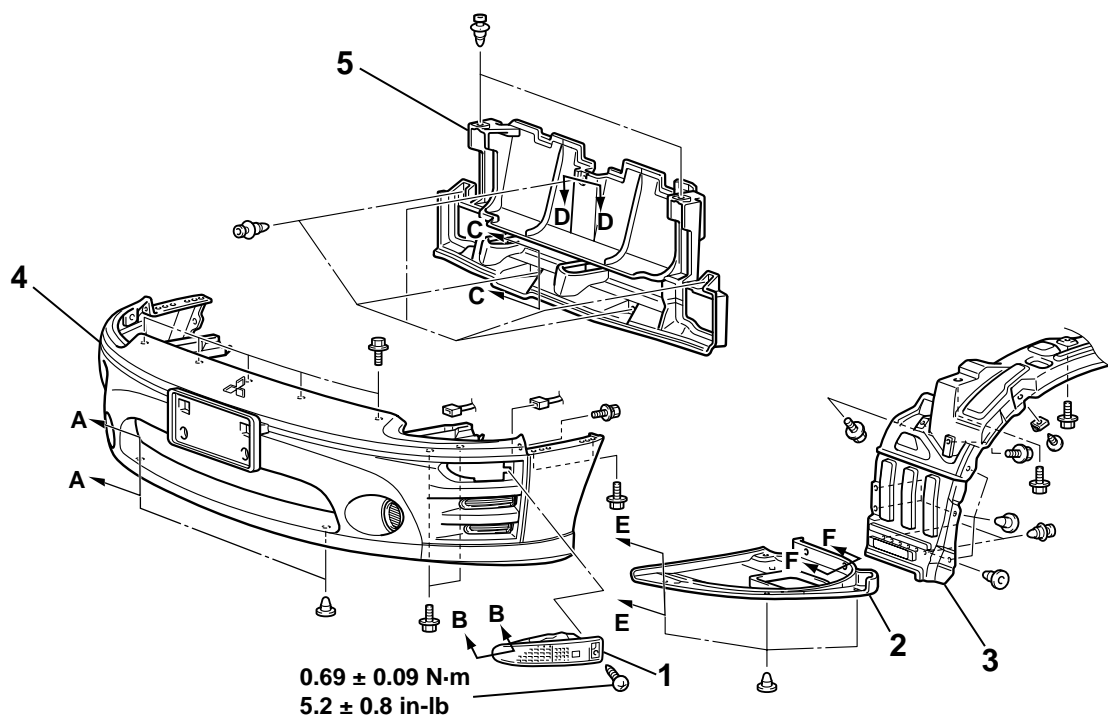

SECTION A – A

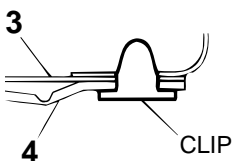

SECTION B – B

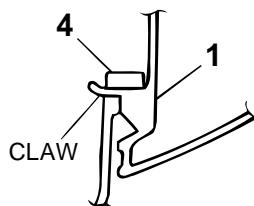

SECTION C – C

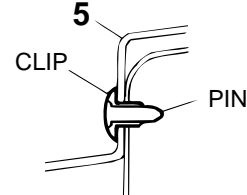

SECTION D – D

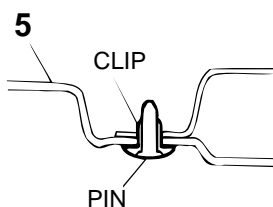

SECTION E – E

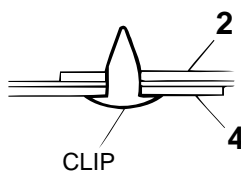

SECTION F – F

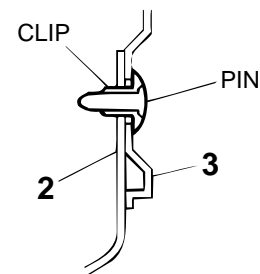

AC106710 AB

REMOVAL STEPS

1. FRONT TURN SIGNAL LIGHT
2. UNDER COVER
3. SPLASH SHIELD

<<A>>

REMOVAL STEPS (Continued)

4. FRONT BUMPER ASSEMBLY
5. AIR GUIDE DUCT

Required Special Tool:

- MB990784: Ornament Remover

REMOVAL SERVICE POINT

<<A>> FRONT BUMPER ASSEMBLY REMOVAL

1. Use special tool MB990784 to pull up the center pin in the clip.
2. Remove the clip.

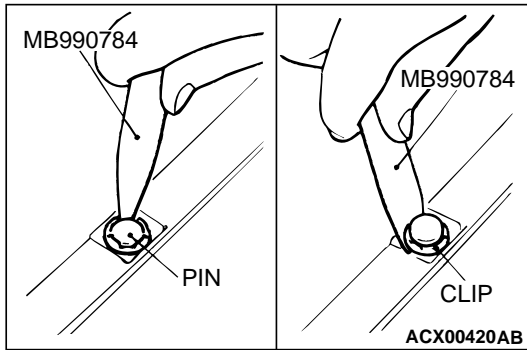

DISASSEMBLY AND ASSEMBLY

M1511001600181

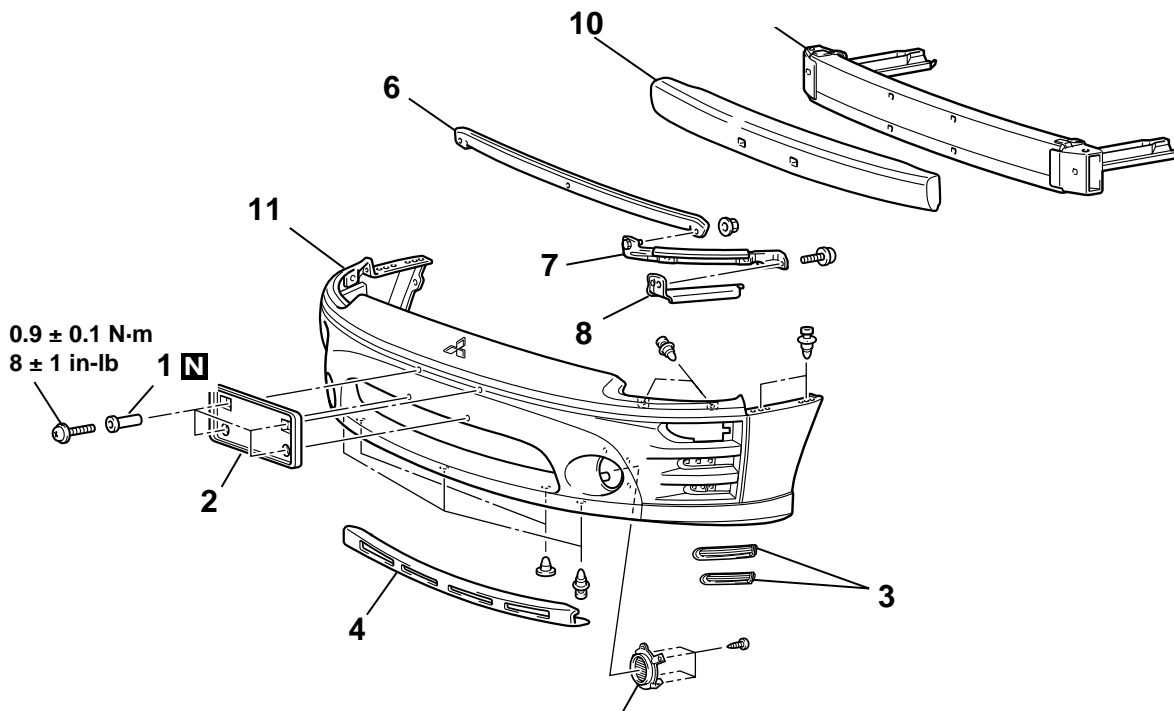

AC106524 AB

DISASSEMBLY STEPS

1. RUBBER NUT
2. LICENCE PLATE GARNISH
3. FRONT BUMPER FACE COVER
4. FRONT BUMPER LOWER PLATE
5. FOG LIGHT HOLE COVER
6. FRONT BUMPER CENTER PLATE
7. FRONT BUMPER SIDE PLATE
8. FRONT BUMPER CORNER PLATE

DISASSEMBLY STEPS (Continued)

9. FRONT BUMPER REINFORCEMENT
10. FRONT BUMPER CORE
11. FRONT BUMPER FACE

<<A>>

Required Special Tool:

- MB990784: Ornament Remover

CLIP AND CLAW POSITION

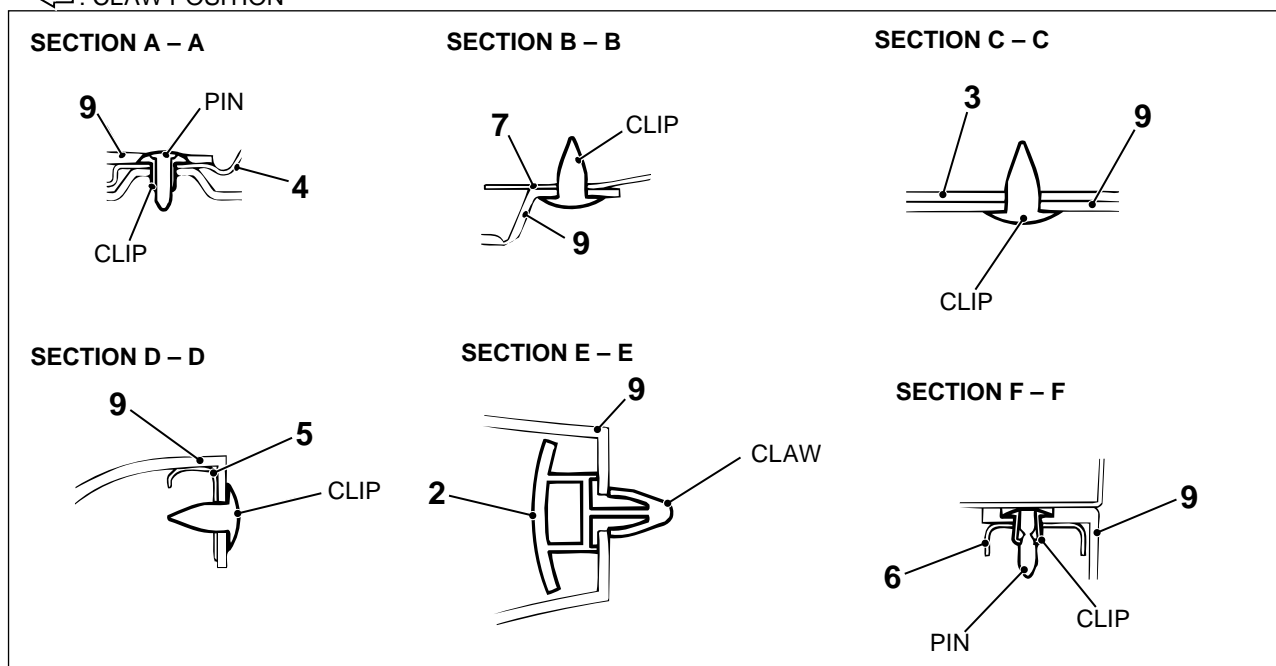
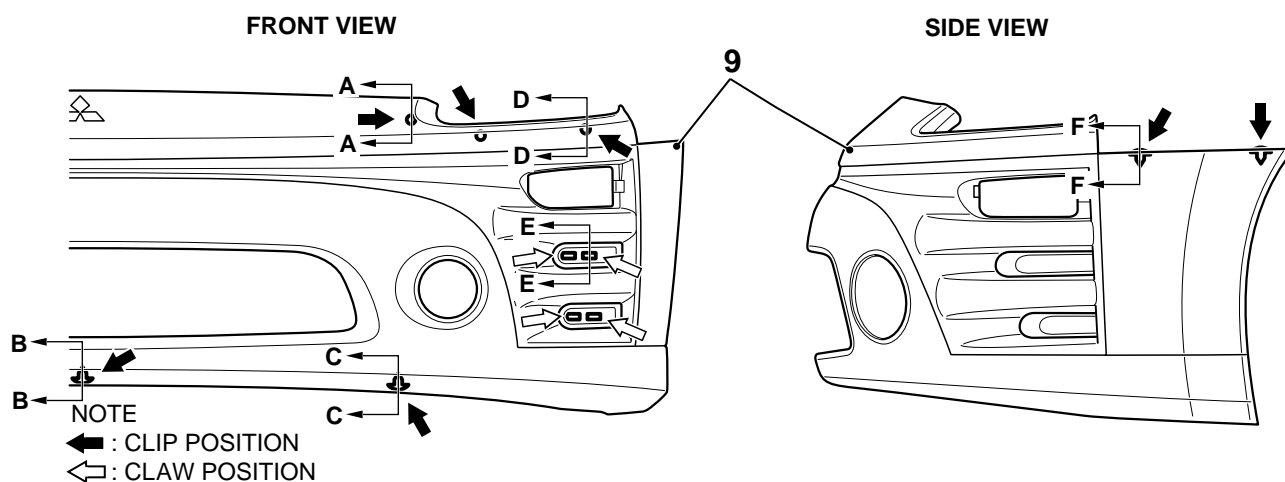

AC106680 AB

DISASSEMBLY SERVICE POINT

<<A>> FRONT BUMPER FACE REMOVAL

1. Use special tool MB990784 to pull up the center pin in the clip.
2. Remove the clip.

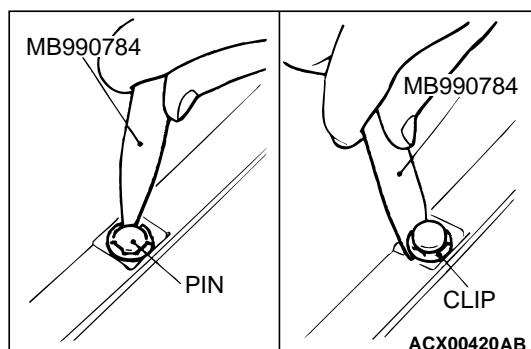

REAR BUMPER ASSEMBLY

SPECIAL TOOL

M1511000600553

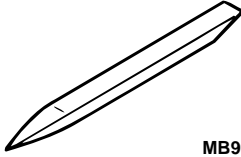
TOOL	TOOL NUMBER AND NAME	SUPERSESSION	APPLICATION
 MB990784	MB990784 Ornament remover	General service tool	Removal of clip

REAR BUMPER ASSEMBLY

REMOVAL AND INSTALLATION

M1511001900085

Pre-removal and Post-installation Operation

- Rear End Trim and Trunk Compartment Trim <ECLIPSE SPYDER> Removal and Installation (Refer to GROUP 52A, Trims [P.52A-9.](#))
- Main Muffler Removal and Installation (Refer to GROUP 15, Exhaust Pipe and Main Muffler <2.4L> [P.15-21.](#))
- Main Muffler Removal and Installation (Refer to GROUP 15, Exhaust Pipe and Main Muffler <3.0L> [P.15-22.](#))

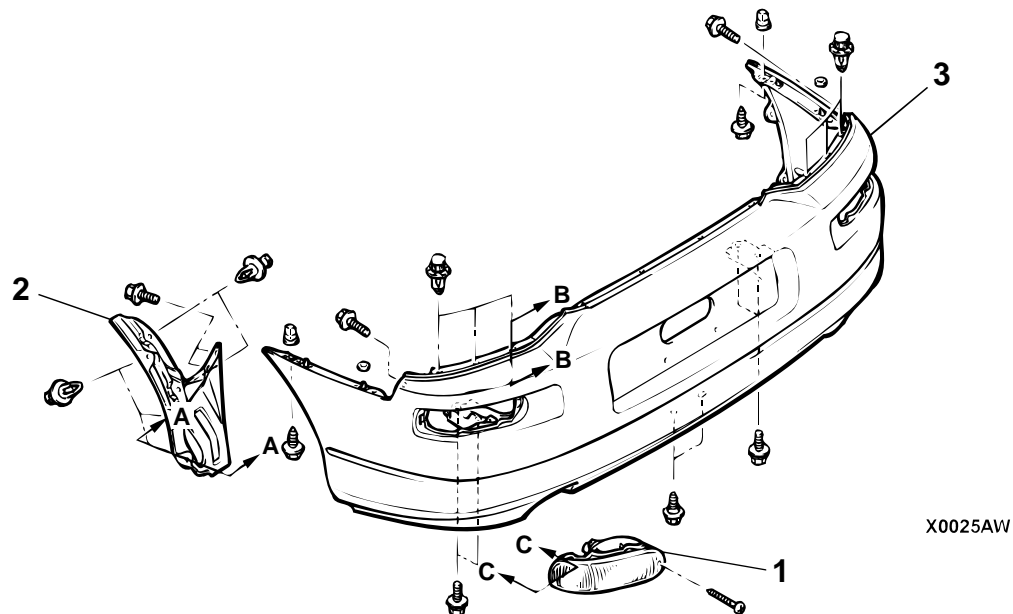

SECTION A - A

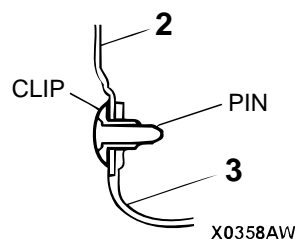

SECTION B - B

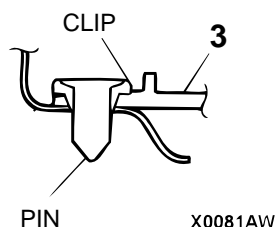

SECTION C - C

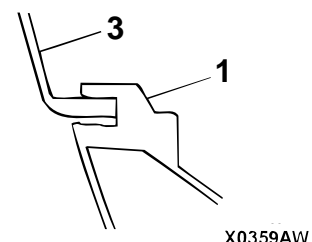

AC003186 AB

REMOVAL STEPS

1. BACKUP LIGHT ASSEMBLY
2. SPLASH SHIELD
3. REAR BUMPER ASSEMBLY

<<A>>

Required Special Tool:

- MB990784: Ornament Remover

REMOVAL SERVICE POINT**<<A>> REAR BUMPER ASSEMBLY REMOVAL**

1. Use special tool MB990784 to pull up the center pin in the clip.
2. Remove the clip.

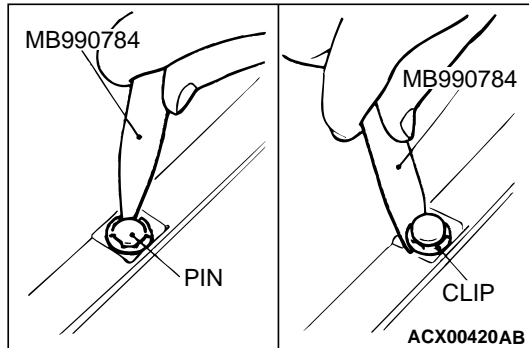

DISASSEMBLY AND REASSEMBLY

M1511002100082

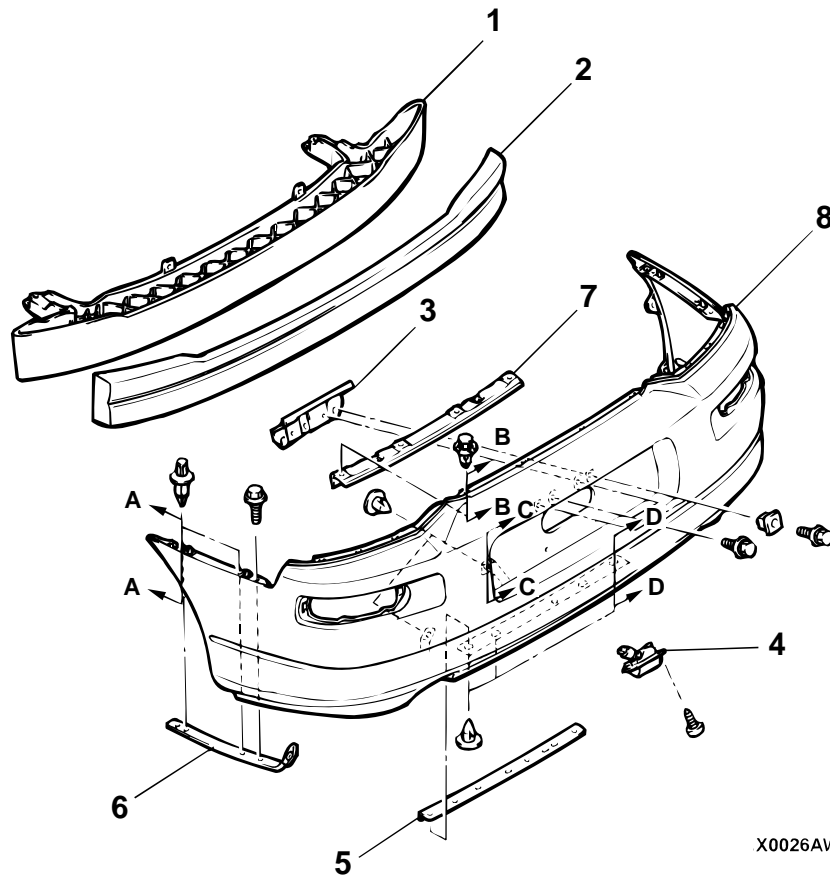

X0026AW

SECTION A - A

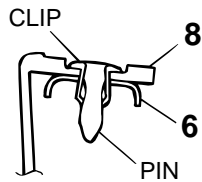

X0082AW

SECTION B - B

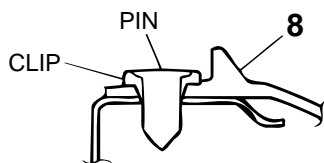

X0083AW

SECTION C - C

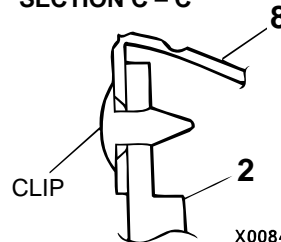

X0084AW

SECTION D - D

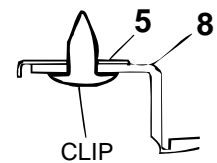

X0454AW

AC003187AB

DISASSEMBLY STEPS

1. REAR BUMPER REINFORCEMENT
2. REAR BUMPER CORE
3. LICENSE PLATE LIGHT BRACKET
4. LICENSE PLATE LIGHT ASSEMBLY
5. REAR BUMPER LOWER PLATE
6. REAR BUMPER SIDE PLATE

<<A>>

7. REAR BUMPER UPPER PLATE
8. REAR BUMPER FACE

Required Special Tool:

- MB990784: Ornament Remover

DISASSEMBLY SERVICE POINT

<<A>> REAR BUMPER FACE REMOVAL

1. Use special tool MB990784 to pull up the center pin in the clip.
2. Remove the clip.

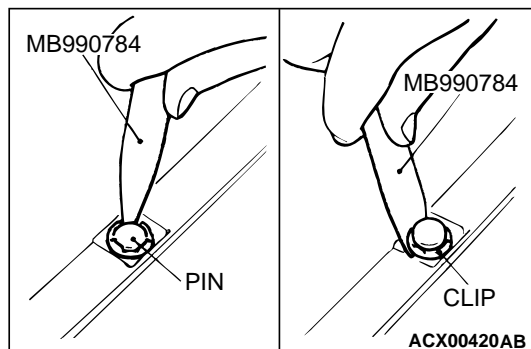

GARNISHES AND MOLDINGS

SPECIAL TOOLS

M1511000600564

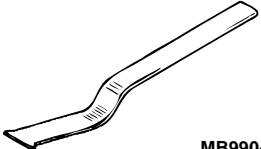
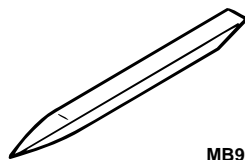
TOOL	TOOL NUMBER AND NAME	SUPERSESSION	APPLICATION
 MB990449	MB990449 Window molding remover	General service tool	Removal of roof drip molding
 MB990784	MB990784 Ornament remover	General service tool	Removal of clip

GARNISHES AND MOLDINGS

REMOVAL AND INSTALLATION

<ECLIPSE>

M1511004400056

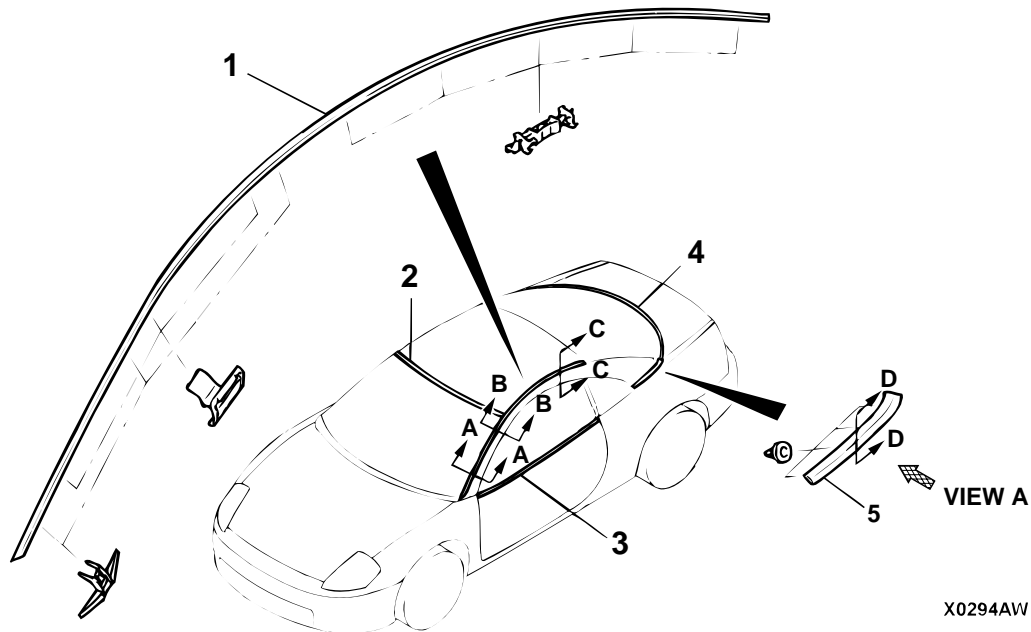

X0294AW

SECTION A – A

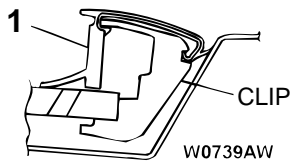

W0739AW

SECTION B – B

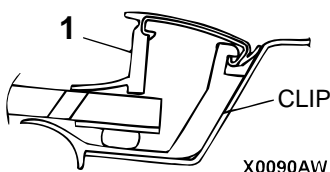

X0090AW

SECTION C – C

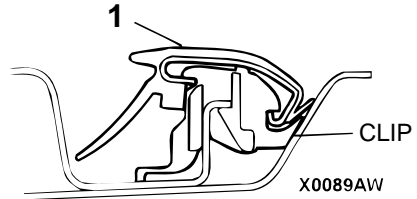

X0089AW

SECTION D – D

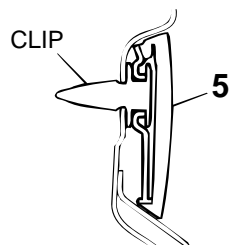

X0099AW

VIEW A

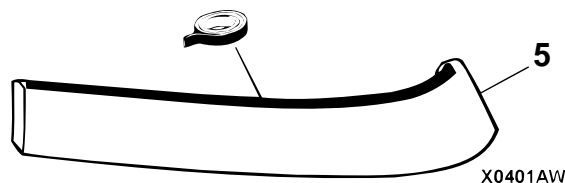

X0401AW

ADHESIVE TAPE: DOUBLE-SIDED TAPE
[3 mm (0.1 in) WIDTH AND 5 mm (0.2 in) THICKNESS]

AC003619AB

- <<A>> >>B<< 1. ROOF DRIP MOLDING
2. WINDSHIELD UPPER MOLDING
(REFER TO GROUP 42, WINDSHIELD P.42-14.)
3. BELT LINE MOLDING (REFER TO GROUP 42 P.42-65.)
- <> >>A<< 4. REAR WINDOW LOWER MOLDING
(REFER TO GROUP 42, LIFTGATE GLASS P.42-23.)
5. REAR PILLAR GARNISH

Required Special Tools:

- MB990449: Window Molding Remover
- MB990784: Ornament Remover

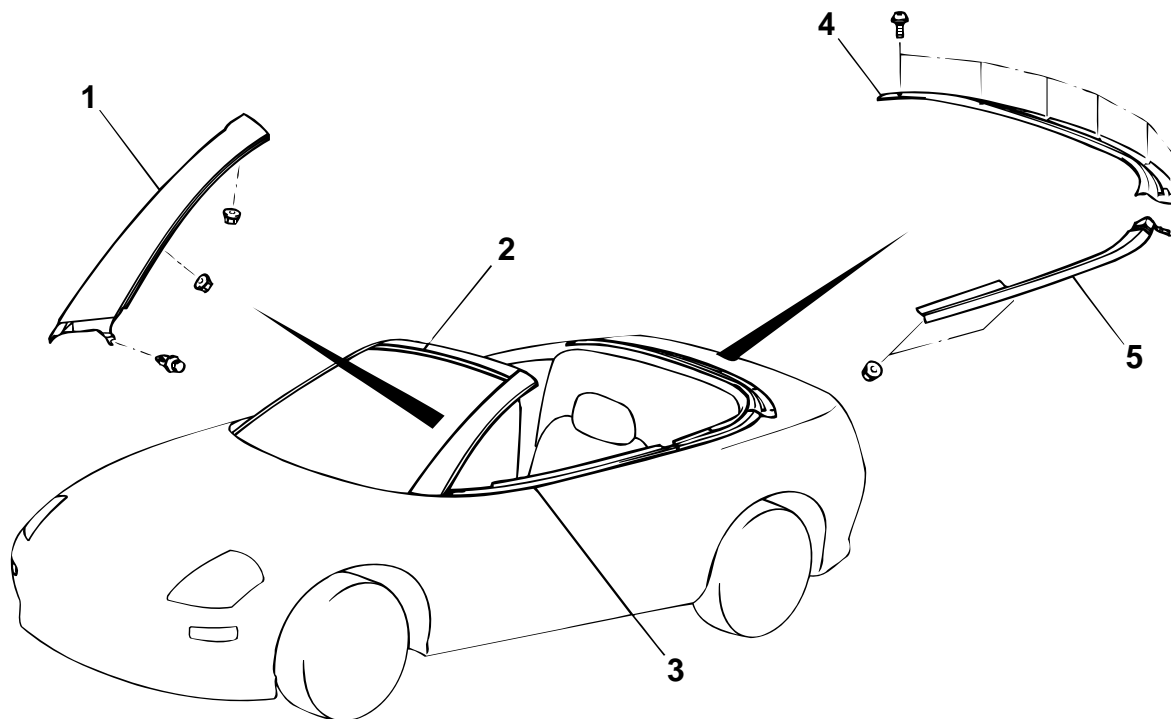
<ECLIPSE SPYDER>AX0890AW
AC003620 AB

1. DRIP GARNISH
2. WINDSHIELD UPPER MOLDING
(REFER TO GROUP 42,
WINDSHIELD [P.42-14.](#))

3. BELT LINE MOLDING (REFER TO
GROUP 42, DOOR WINDOW
GLASS RUNCHANNEL AND DOOR
OPENING WEATHERSTRIP [P.42-
65.](#))
4. BACK BELT MOLDING
5. QUARTER BELT SIDE GARNISH

REMOVAL SERVICE POINTS

<<A>> ROOF DRIP MOLDING REMOVAL

CAUTION

If the molding has become warped, it should not be reused.

Use special tool MB990449 to lever out the molding.

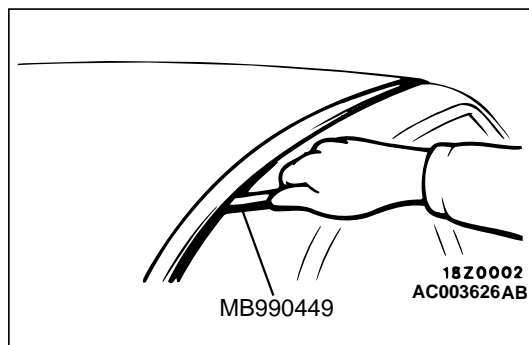

<> REAR PILLAR GARNISH REMOVAL

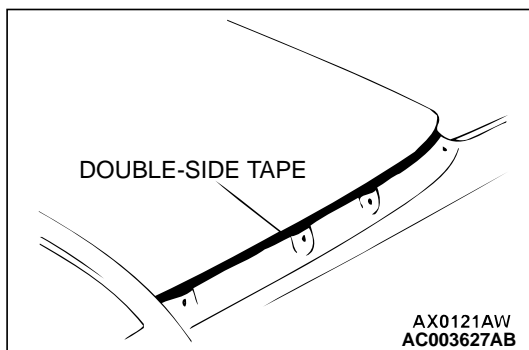

1. Use a resin spatula to scrape off the double-sided tape.
2. Wipe the body surface and clean it with a shop moistened with isopropyl alcohol.

INSTALLATION SERVICE POINTS

>>A<< REAR PILLAR GARNISH INSTALLATION.

1. Scrape off the double-sided tape with a resin spatula or gasket scraper.

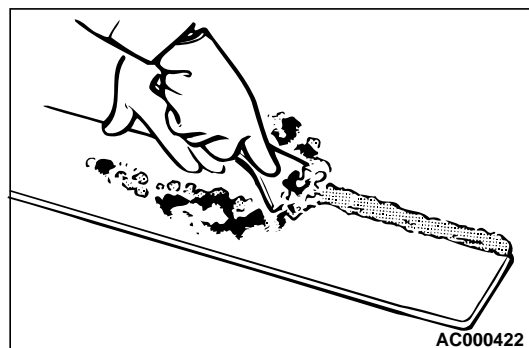

2. Use a shop towel moistened with 3M™ AAD Part number 8906 or equivalent to wipe the protect molding surface.

CAUTION

Do not remove all of the residual adhesive.

3. Remove only a small portion of the residual adhesive.

CAUTION

- Always apply it evenly on the entire surface, because a lot or little will reduce its strength.
- Do not touch the painted surface.

4. Affix the specified double-sided tape [3 mm (0.1 inch) wide and 5 mm (0.2 inch) thick].

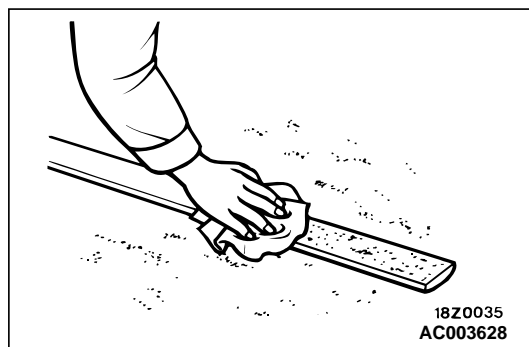

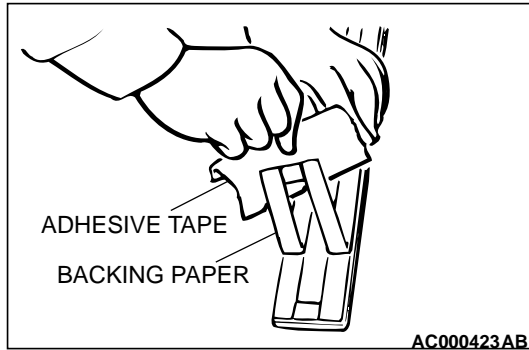
**REAR PILLAR GARNISH INSTALLATION**

1. Tear off the double-sided tape backing paper.

NOTE: If you attach the adhesive tape to the edge of the backing paper, it will be easy to tear off.

2. Install the rear pillar garnish.

NOTE: If the double-sided tape is difficult to affix in cold temperature, etc., warm the bonding surfaces of the body and rear pillar garnish to about 40 – 60°C (104 – 140°F) before affixing the tape.

3. Firmly press in the rear pillar garnish.

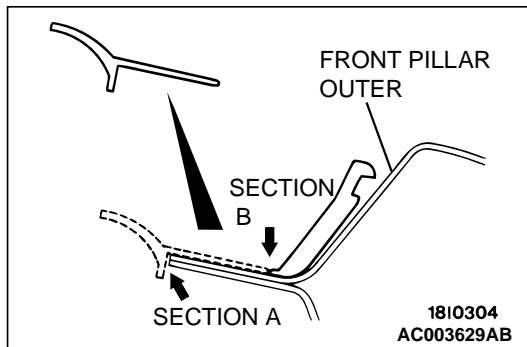
**>>B<< ROOF DRIP MOLDING INSTALLATION**

After installing the clip to the outer front pillar in alignment with its section A, cut from section B.

AERO PARTS

REMOVAL AND INSTALLATION

M1511005000039

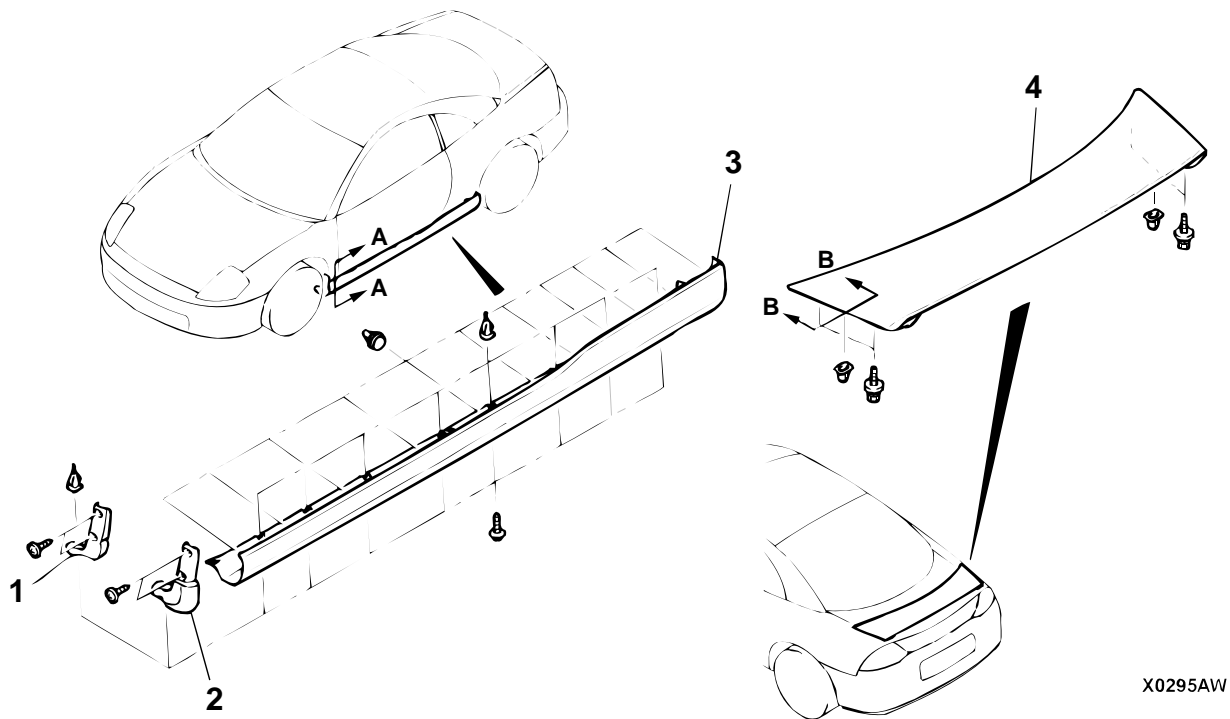

X0295AW

SECTION A – A

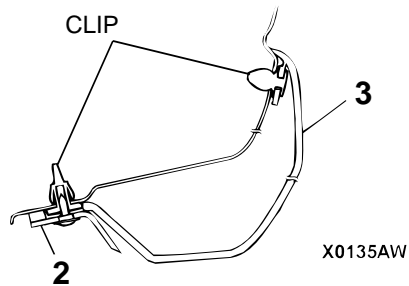

X0135AW

SECTION B – B

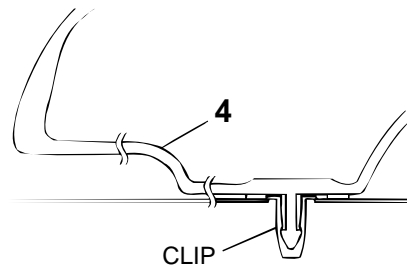

X0100AW

AC003621AB

REMOVAL STEPS

1. STONE GUARD <VEHICLES WITHOUT SIDE AIR DAM>
2. FRONT SIDE AIR DAM
3. REAR SIDE AIR DAM
4. REAR SPOILER

WINDSHIELD WIPER AND WASHER

GENERAL INFORMATION

OPERATION

Windshield Low-speed (and High-speed) Wiper Operation

- If the wiper switch is turned to the "LO" position with the ignition switch at the "ACC" or "ON" position, the column switch sends a low-speed wiper ON and high-speed wiper OFF signals to the front-ECU. This turns the wiper signal on and the wiper speed switching relay off (low-speed), causing the wipers to operate at low-speed.
- If the wiper switch is turned to the "HI" position, the column switch sends a low-speed wiper OFF and high-speed wiper ON signals to the front-ECU. This turns both the wiper signal and the wiper speed switching relay on (high-speed), causing the wipers to operate at high-speed.

Windshield Intermittent Wiper Operation

- The ETACS-ECU calculates the wiper operation interval according to the voltage signal sent from the column switch. Then the ETACS-ECU sends a signal to the front-ECU. The front-ECU determines the wiper operation interval and turns on the wiper relay signal. This causes the wiper auto stop relay to turn on. Then the wiper auto stop relay will turn off after the wipers reach the park position. This causes the wiper signal relay and then the wipers to turn off. If the wiper signal relay remains off for the wiper operation interval, the relay turns on again, causing the wipers to operate in intermittent mode.

WINDSHIELD WIPER AND WASHER DIAGNOSIS

The windshield wiper and washer are controlled by ETACS-ECU. For troubleshooting, refer to GROUP 54B, SWS Diagnosis [P.54B-17](#).

M1511000100116

Windshield Mist Wiper Operation

- If the wiper switch is turned to the "MIST" position with the ignition switch at "ACC" or "ON" position, the mist wiper high-speed operation signal is sent to the front-ECU. This signal turns on the wiper speed switching relay, causing the wipers to work at high-speed while the mist switch is on.
- While the mist wiper switch remains turned on when the intermittent mode is still working, the wipers work as the mist wiper. However, the wipers return to the intermittent mode again when the wiper auto stop signal turns on after the mist wiper switch is turned off.

Windshield Washer Operation

- If the wiper switch is turned to the "WASHER" position with the ignition switch at "ACC" or "ON" position, the washer ON signal is sent to the front-ECU, causing the wiper signal to turn on after 0.6 seconds. After the washer switch signal turns off, the wiper signal turns off in three seconds. If the wiper switch is turned the "WASHER" position while the wiper is at intermittent mode, the washer works for that period when the washer switch remains on. Then the wipers return to the intermittent mode.

M1511000700099

WINDSHIELD WIPER AND WASHER REMOVAL AND INSTALLATION

M1511007600134

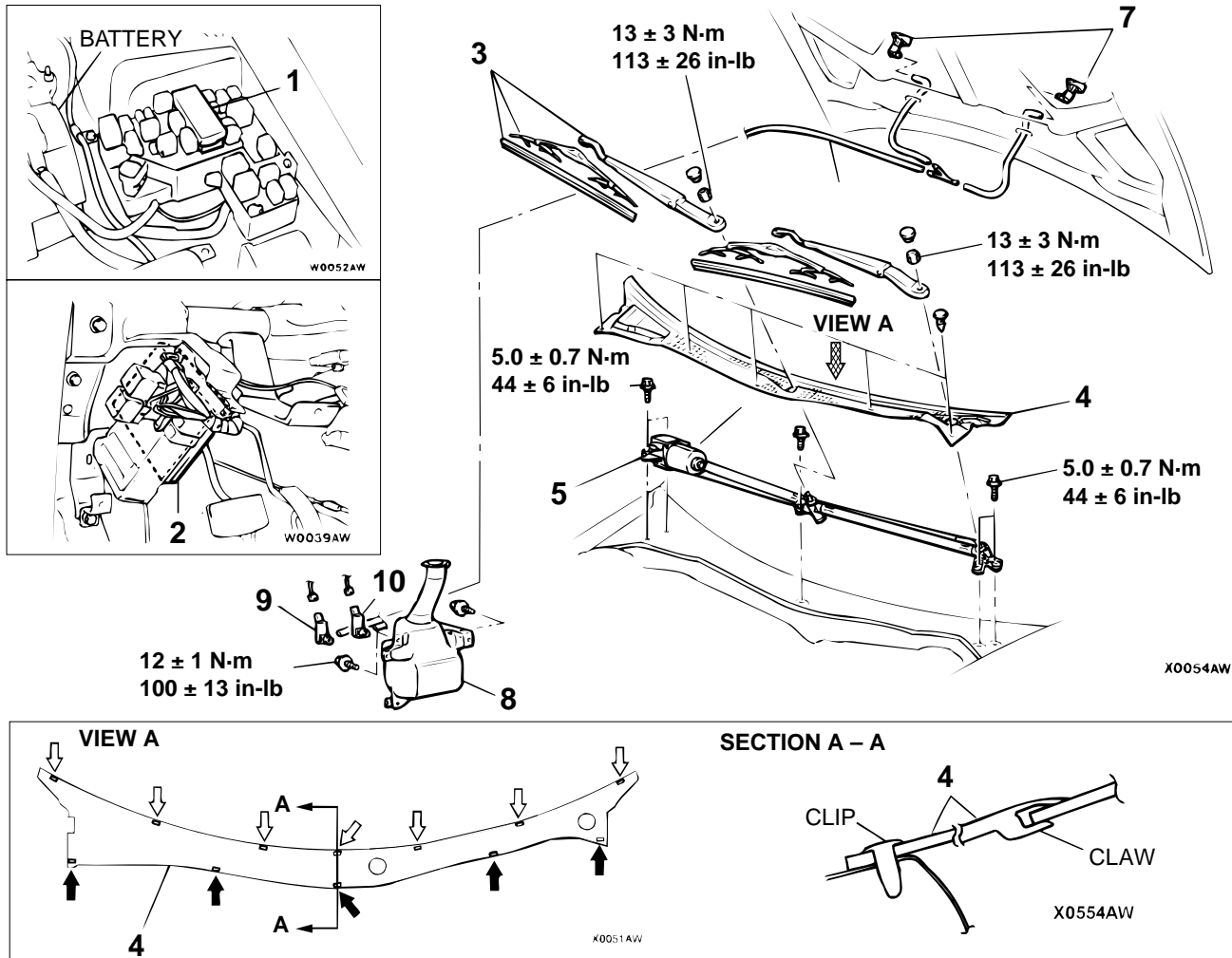

NOTE

- ◀: CLIP POSITION
◀: CLAW POSITION

AC003326 AB

1. FRONT-ECU

2. ETACS-ECU

WIPER MOTOR AND LINK ASSEMBLY REMOVAL STEPS

>>B<< 3. WIPER ARM AND BLADE
ASSEMBLY

4. FRONT DECK GARNISH

<<A>> >>A<< 5. WIPER MOTOR AND LINK
ASSEMBLY

WASHER NOZZLE REMOVAL STEPS

• FRONT SPLASH SHIELD

6. WASHER HOSE

7. WASHER NOZZLE

WASHER TANK REMOVAL STEPS

• FRONT SPLASH SHIELD (REFER
TO GROUP 42, FENDER P.42-9.)

• FRONT BUMPER ASSEMBLY
(REFER TO GROUP 51P.51-4.)

WASHER TANK REMOVAL STEPS

• PASSENGER'S SIDE HEADLIGHT
(REFER TO GROUP 54A P.54A-
111.)

• WASHER FLUID DRAINING AND
REFILLING

6. WASHER HOSE

8. WASHER TANK ASSEMBLY

9. FRONT WINDSHIELD WASHER
MOTOR

10. REAR WINDSHIELD WASHER
MOTOR

*NOTE: For removal and installation of the wiper and
washer switch, refer to GROUP 54A P.54A-122, Col-
umn Switch.*

REMOVAL SERVICE POINT**<<A>> WIPER MOTOR AND LINK ASSEMBLY REMOVAL**

1. Remove the five mounting bolts of the wiper motor and link assembly and disconnect the connector.
2. To protect the windshield, apply duct tape to the entire circumference of the glass near the wiper motor and link assembly installation position.

⚠ CAUTION

Be careful not to damage the windshield glass when removing the wiper motor and link assembly.

3. Use a flat-tipped screwdriver to disengage the driver's side link from the center crank arm.
4. Remove the wiper motor and link assembly from the vehicle body (the cowl) while being careful not to scratch the windshield glass.

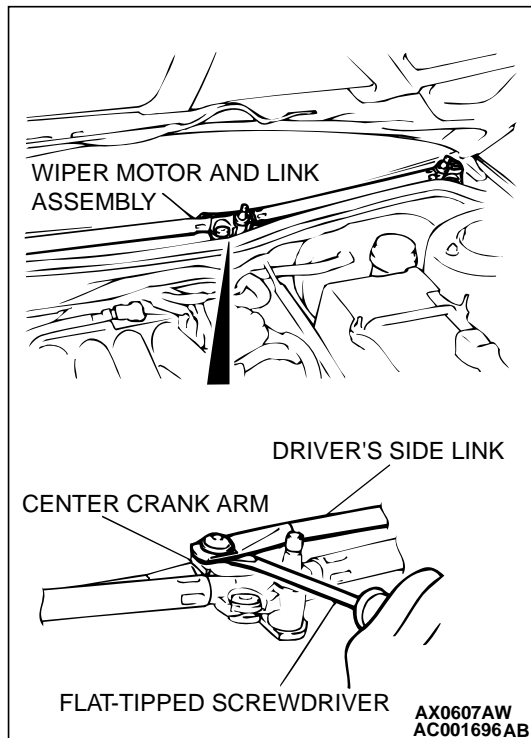
**INSTALLATION SERVICE POINTS****>>A<< WIPER MOTOR AND LINK ASSEMBLY INSTALLATION**

1. Disengage the driver's side link from the center crank arm when replacing with new one.

⚠ CAUTION

Be careful not to scratch the windshield glass when installing the wiper motor and link assembly.

2. Install the wiper motor and link assembly to the vehicle body (the cowl) while being careful not to scratch the windshield glass.

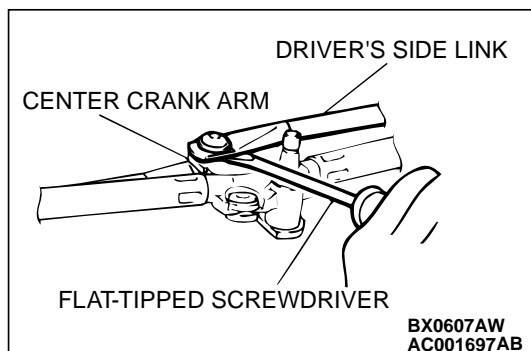

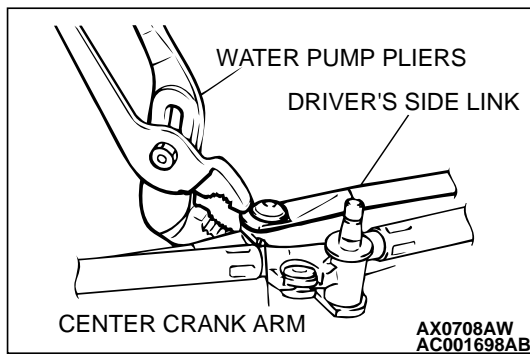

3. Use water pump pliers to engage securely the driver's side link with the center crank arm.

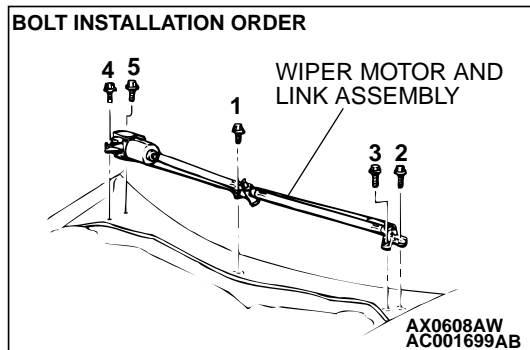

4. Install the five mounting bolts in the shown order to install the wiper motor and link assembly.
5. Secure the wiper motor and link assembly in the wiper park position. (Refer to, Wiper Motor Check [P.51-20.](#))

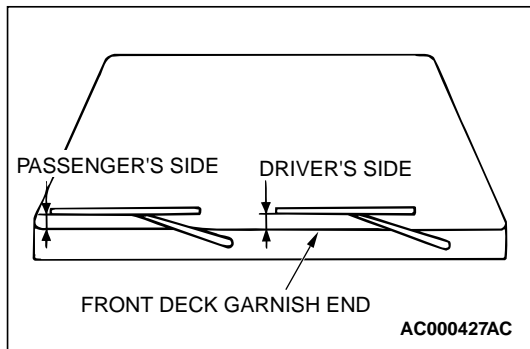

>>B<< WIPER ARM AND BLADE ASSEMBLY INSTALLATION

Install the wiper blade at the specified position (standard value).

Standard value:

Driver's side: 33 – 43 mm (1.3 – 1.7 inches)

Passenger's side: 38 – 48 mm (1.5 – 1.9 inches)

INSPECTION

M1511019100192

FRONT WIPER MOTOR CHECK

Check the wiper motor after disconnecting the wiring harness connector, and with the wiper motor remaining installed to the body.

Wiper Motor at Low-Speed and High-Speed Operation

Connect the battery to the wiper motor as shown in the illustration, and then check the operation of the wiper motor at low speed and at high speed.

Wiper Motor at Stop Position Operation

1. Run the wiper motor at low-speed, disconnect the battery, and stop the motor.
2. Reconnect the battery as shown in the illustration, and confirm that the motor starts turning at low-speed, and then stops at the automatic stop position.

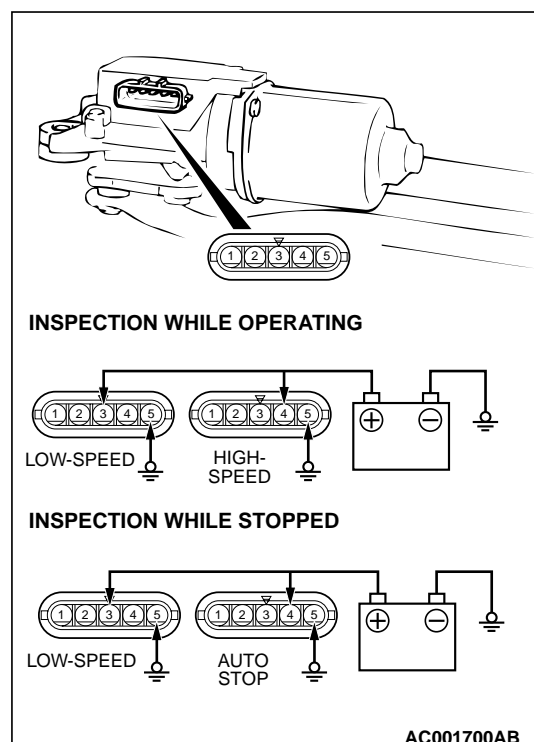

FRONT WASHER MOTOR CHECK

1. With the washer motor installed to the washer tank, fill the washer tank with water.
2. Check that water is sprayed out strongly when battery voltage is applied to terminal (1) and terminal (2) is grounded.

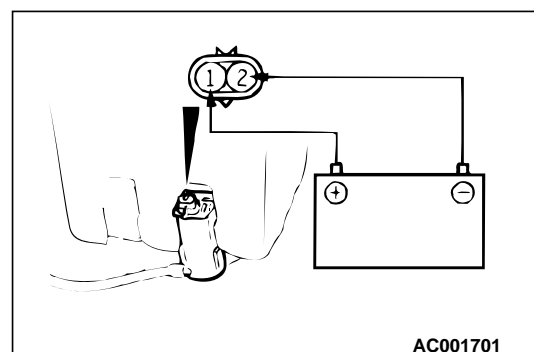

WINDSHIELD WIPER AND WINDSHIELD WASHER SWITCH CHECK

1. Windshield wiper and washer switch

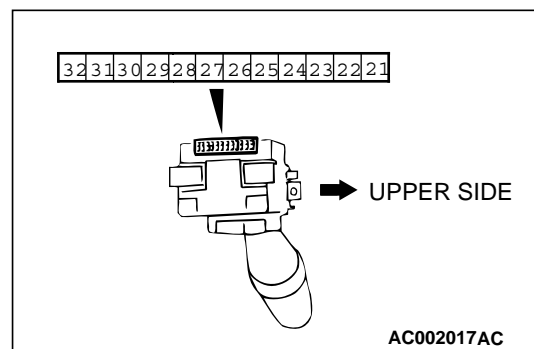

SWITCH POSITION	TESTER CONNECTION	SPECIFIED CONDITION
OFF	21 - 23 , 22 - 23 , 23 - 30 , 23 - 31 , 23 - 32	Open circuit
Windshield mist wiper switch	23 - 32	Less than 2 ohm
Windshield intermittent wiper switch	23 - 31	Less than 2 ohm

SWITCH POSITION	TESTER CONNECTION	SPECIFIED CONDITION
Windshield low-speed wiper switch	23 – 30	Less than 2 ohm
Windshield high-speed wiper switch	21 – 23	Less than 2 ohm
Windshield washer switch	22 – 23	Less than 2 ohm

2. Windshield intermittent wiper interval adjusting knob
Measure the resistance value at terminal numbers 27 and 28. The resistance value should rise smoothly from approximately 0 Ω ("FAST" position) to approximately 1 k Ω ("SLOW" position).

REAR WIPER AND WASHER

GENERAL INFORMATION

OPERATION

Rear Wiper Operation

- If the rear wiper and washer switch is turned to the "INT" position with the ignition switch at "ACC" or "ON" position, the ETACS-ECU causes the rear wiper to operate continuously two times, then intermittently at eight-second intervals.
- If the selector lever is moved to the "R" position when the rear wiper and washer switch is turned to the "INT" position and the ignition switch at "ACC" or "ON" position, park/neutral position switch "R" turns ON. One second later, the ETACS-ECU causes the rear wiper to operate two times continuously to ensure good rearward visibility. The ETACS-ECU then causes the rear wiper to again operate intermittently at eight-second intervals.

EXTERIOR DIAGNOSIS

The rear wiper and washer are controlled by ETACS-ECU. For troubleshooting, refer to GROUP 54B, SWS Diagnosis [P.54B-17](#).

M1511000100138

Rear Washer Operation

- If the rear wiper and washer switch is turned to the "WASHER" position with the ignition switch at "ACC" or "ON" position, the rear washer ON signal is sent to the ETACS-ECU, causing the rear wiper signal to turn on after 0.9 seconds. After the rear washer switch signal turns off, the rear wiper signal turns off in three seconds.
- If the rear wiper and washer switch is turned to the "WASHER" position while the rear wiper is at intermittent mode, the rear washer works for that period when the washer switch remains on. Then the rear wipers return to the intermittent mode.

M1511000700118

REAR WIPER

REMOVAL AND INSTALLATION

M1511008800045

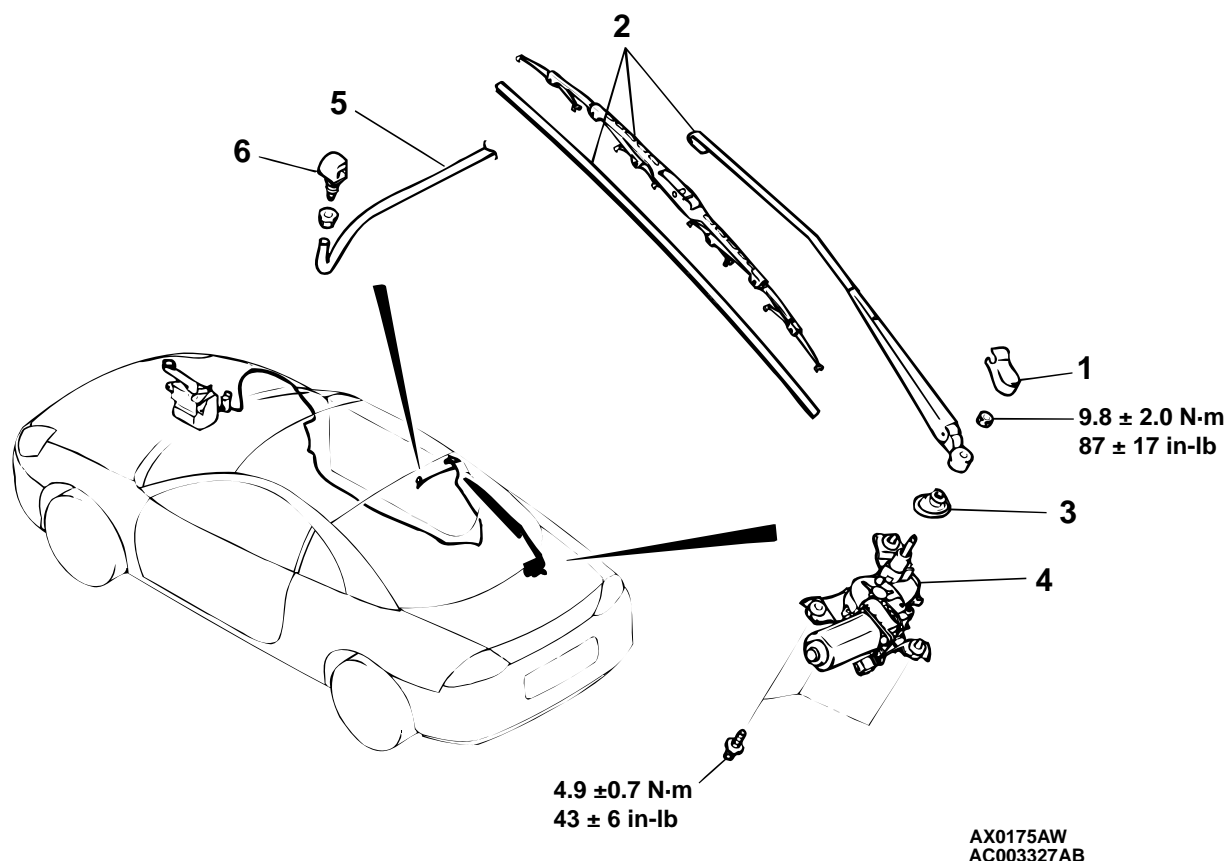

- WASHER TANK ASSEMBLY AND REAR WASHER MOTOR (REFER TO GROUP 51, WINDSHIELD WIPER AND WASHER [P.51-17.](#))

**REAR WIPER MOTOR ASSEMBLY
REMOVAL STEPS**

1. COVER
- >>A<< 2. REAR WIPER ARM AND BLADE ASSEMBLY
- LIFTGATE LOWER TRIM (REFER TO GROUP 42, LIFTGATE TRIM [P.42-72.](#))
- >>B<< 3. GROMMET
4. REAR WIPER MOTOR ASSEMBLY

**REAR WASHER HOSE REMOVAL
STEPS**

- QUARTER TRIM, LOWER <RH> (REFER TO GROUP 52A, TRIMS [P.52A-9.](#))
- 5. REAR WASHER HOSE
- >>A<< 6. WASHER NOZZLE

NOTE: For removal and installation of the wiper and washer switch, refer to GROUP 54A, Column Switch [P.54A-122.](#)

INSTALLATION SERVICE POINTS

>>A<< WASHER NOZZLE INSTALLATION

Install the washer nozzle in the specified direction.

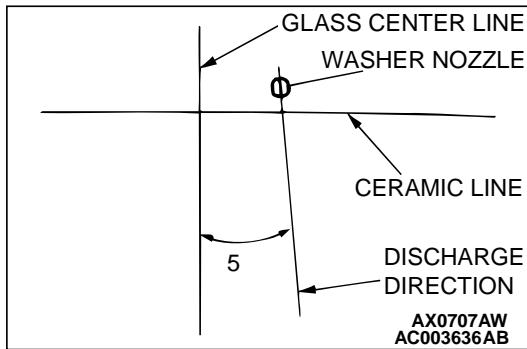

>>B<< GROMMET INSTALLATION

Install the grommet so that the arrow points upwards.

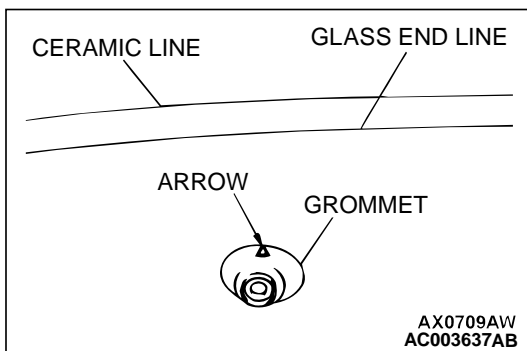

>>C<< REAR WIPER ARM AND BLADE ASSEMBLY INSTALLATION

Install the wiper blade so that the tip stops at the standard position (standard value), and also so that the lower section of the wiper blade enters the middle of the defogger pattern.

Standard value (A): 89 – 99 mm (3.5 ± 3.9 inches)

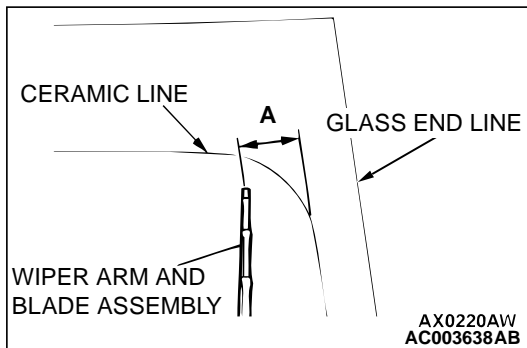

INSPECTION

M1511019100200

REAR WIPER MOTOR CHECK

Check the wiper motor after first disconnecting the wiring harness connector, and with the wiper motor remaining installed to the body.

Wiper Motor Operation

Connect a battery to the wiper motor as shown in the illustration and inspect the motor operation.

Wiper Motor at Stop Position Operation

1. Run the wiper motor, disconnect the battery, and stop the motor.
2. Reconnect the battery as shown in the illustration, and confirm that after the motor starts turning it stops at the automatic stop position.

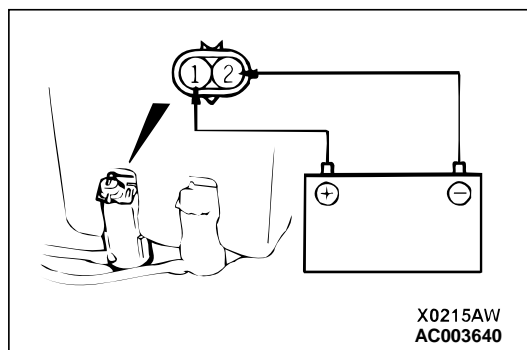
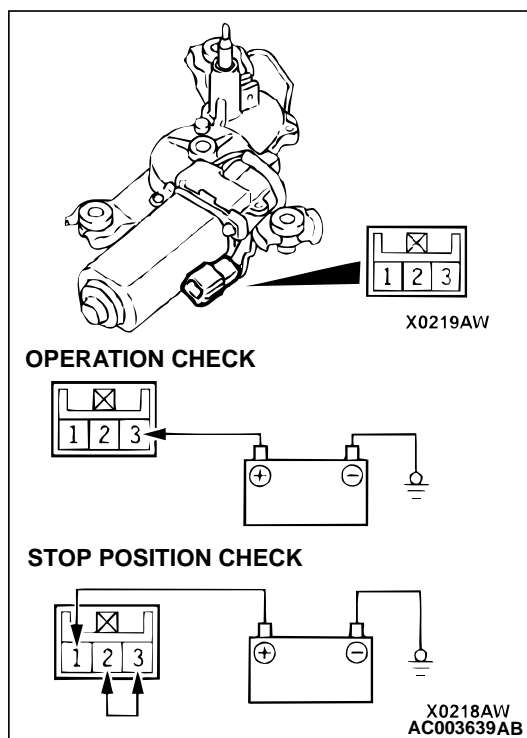

REAR WASHER MOTOR CHECK

1. With the washer motor installed to the washer tank, fill the washer tank with water.
2. When the battery is connected as shown in the figure, check that the washer squirts out strongly.

REAR WIPER AND WASHER SWITCH INSPECTION

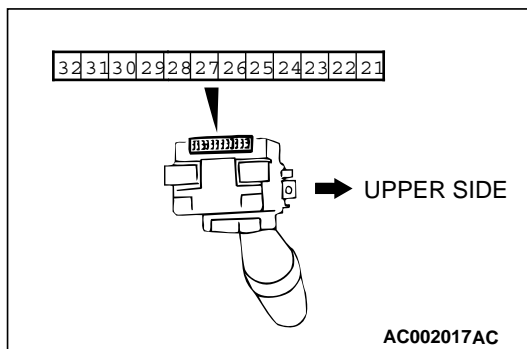

SWITCH POSITION	TERMINAL CONNECTION	SPECIFIED CONDITION
OFF	25 - 26 , 25 - 29	Open circuit
Rear wiper switch ON	25 - 26	Less than 2 ohm
Rear washer switch ON	25 - 29	Less than 2 ohm

MARK

SPECIAL TOOL

M1511000600575

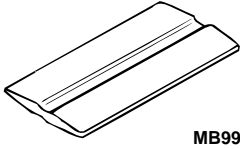
TOOL	TOOL NUMBER AND NAME	SUPERSESSION	APPLICATION
 MB990528	MB990528 Stripe tape spatula	-	Bonding of the mark

MARK

REMOVAL AND INSTALLATION

M1511011800067

< ECLIPSE >

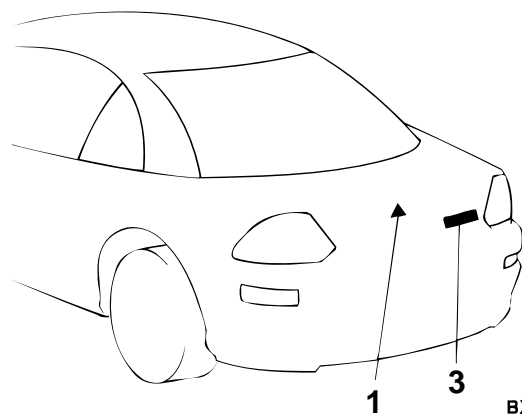
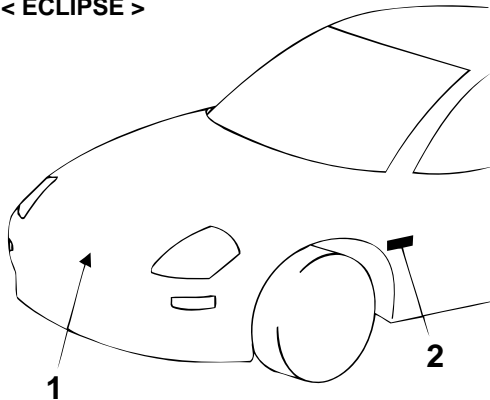

BX0231AW

< ECLIPSE SPYDER >

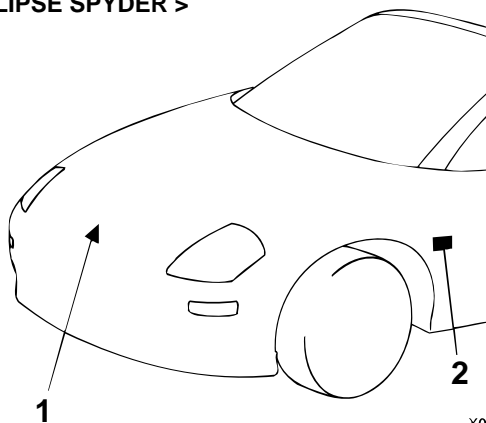

X0828AW

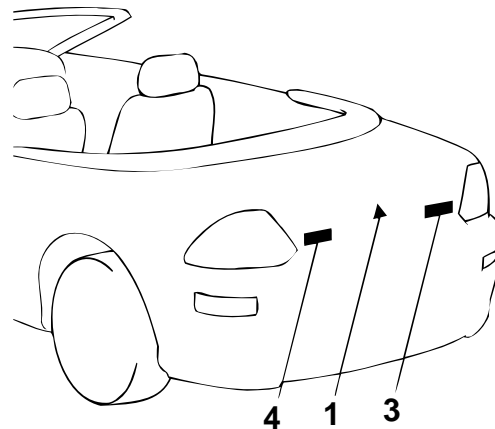
X0829AW
AC003660AB

1. TOP MARK
 >>A<< 2. ENGINE SPECIFICATION MARK
 >>A<< 3. GRADE MARK (GT, RS, GS)
 >>A<< 4. SPYDER MARK

Required Special Tool:

- MB990528: Stripe Tape Spatula

INSTALLATION SERVICE POINT

>>A<< MARK INSTALLATION

1. APPLICATION LOCATION

The distance A (from the mark right end to the notch) should be identical to the distance A' (from the front door opening line to the mark right end).

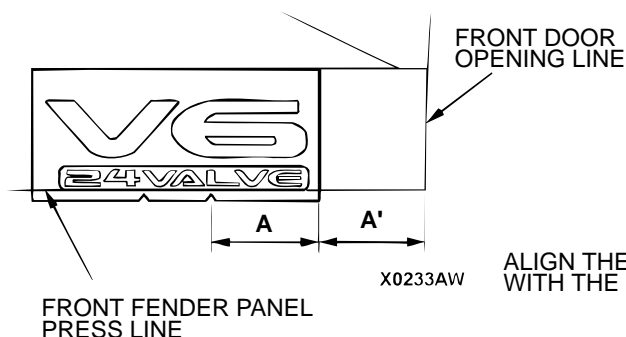
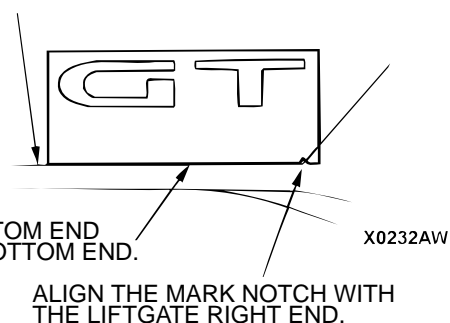
ENGINE SPECIFICATION MARK
LH SIDEGRADE MARK
GT (ALSO APPLICABLE FOR GS)

NOTE
RH SIDE IS SYMMETRICAL ON LH SIDE.

SPYDER MARK

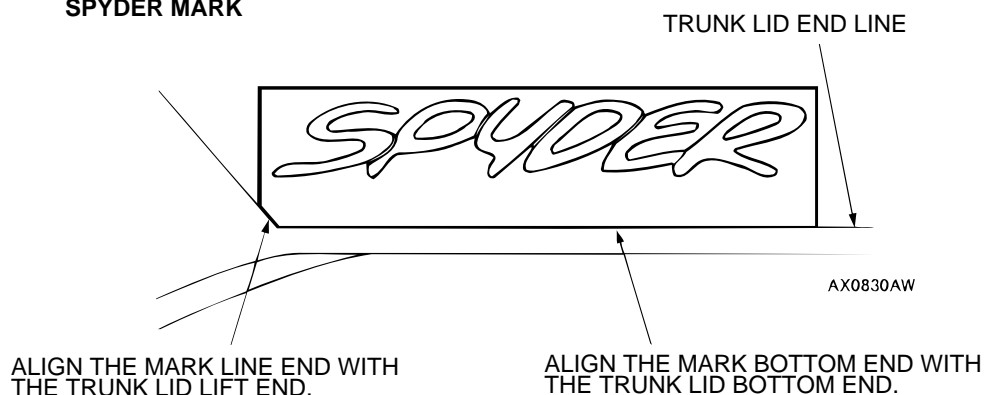

AC003661AB

⚠ CAUTION

- Work in a dust-free workplace with temperature of 20 – 38°C (60 - 100°F).
- If workplace temperature is under 20°C (60°F), warm tape and vehicle body (adhesion area) to 20 – 38°C (60 – 100°F).

2. Install the tape by the following procedure.

- (1) Use 3M™ AAD Part number 8906 or equivalent to wipe off oil from stripe tape adhesion area.
- (2) Remove protective paper from back of stripe tape and adhere entirely to indicated area.

⚠ CAUTION

- Pressing the mark horizontally may lead to a slack, clinching or improper position.
- If the mark is pressed improperly, the mark may be easily peeled off.

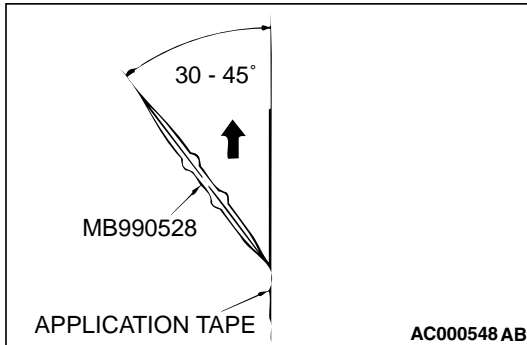

- (3) Make sure that air bubbles are not trapped in the application surface. When applying the mark, use special tool MB990528 to press the mark from its center to top and bottom gradually.

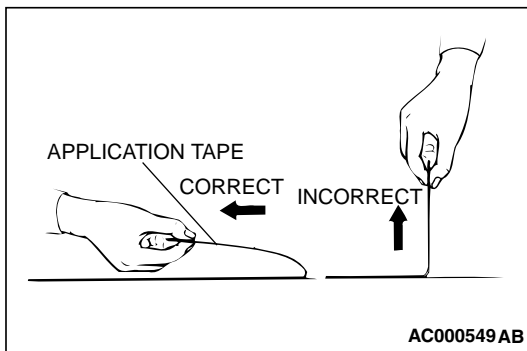

- (4) Peel off an application tape (top protection paper) horizontally and carefully from one end. If an air bubble is left in the mark, open a hole by using a needle, and then use special tool MB990528 to expel the air bubble.

DOOR MIRROR

SPECIAL TOOL

M1511000600586

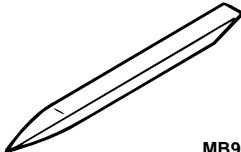
TOOL	TOOL NUMBER AND NAME	SUPERSESSION	APPLICATION
 <p>MB990784</p>	MB990784 Ornament remover	General service tool	Removal of remote controlled mirror switch

DOOR MIRROR

REMOVAL AND INSTALLATION

M1511006400063

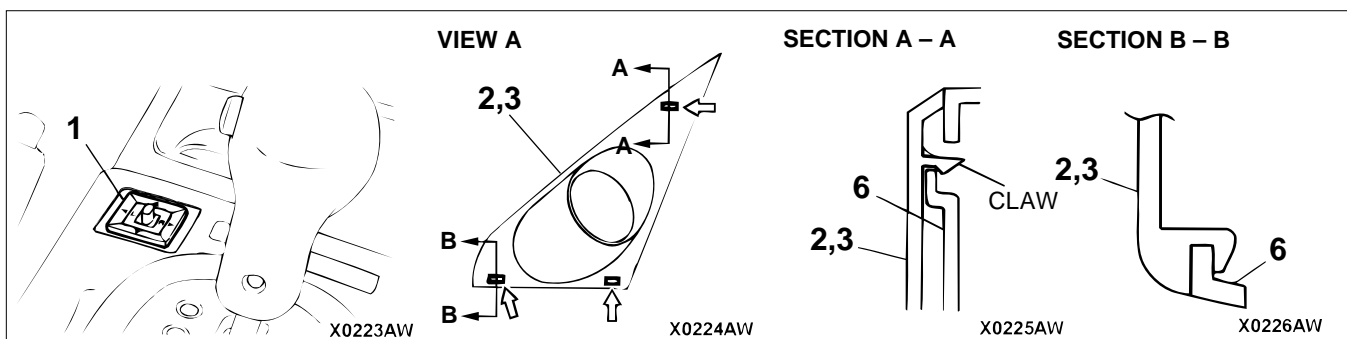
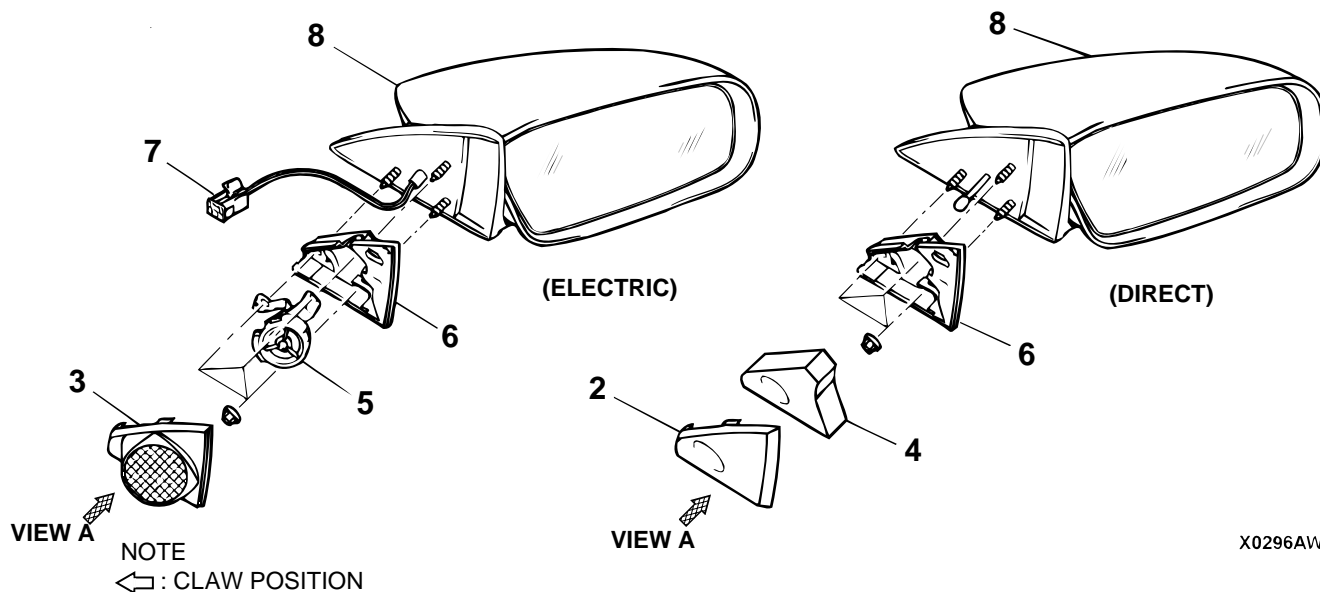

1. REMOTE CONTROLLED MIRROR SWITCH

DOOR MIRROR REMOVAL STEPS

- DOOR TRIM (REFER TO GROUP 42 P.42-54.)
- 2. DELTA COVER, INNER
- 3. TWEETER COVER
- 4. PAD

DOOR MIRROR REMOVAL STEPS

5. TWEETER
6. DELTA COVER BASE
7. HARNESS CONNECTOR
<VEHICLES WITH REMOTE CONTROLLED MIRROR>
8. DOOR MIRROR ASSEMBLY

INSPECTION

M1511019100211

ELECTRIC REMOTE CONTROL MIRROR
OPERATION CHECK

Check that the mirror moves as described in the table when each terminal is connected to the battery.

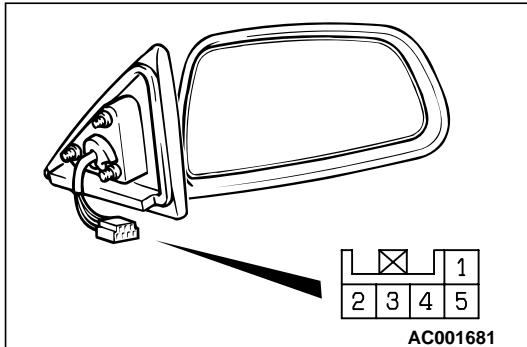

DIRECTION OPERATION	TESTER CONNECTION	SPECIFIED CONDITION
Up	<ul style="list-style-type: none"> Connect terminal 3 to the negative battery terminal Connect terminal 1 to the positive battery terminal 	Less than 2 ohm
Down	<ul style="list-style-type: none"> Connect terminal 1 to the negative battery terminal Connect terminal 3 to the positive battery terminal 	Less than 2 ohm
Right	<ul style="list-style-type: none"> Connect terminal 3 to the negative battery terminal Connect terminal 2 to the positive battery terminal 	Less than 2 ohm
Left	<ul style="list-style-type: none"> Connect terminal 2 to the negative battery terminal Connect terminal 3 to the positive battery terminal 	Less than 2 ohm

DOOR MIRROR CONTROL SWITCH CHECK

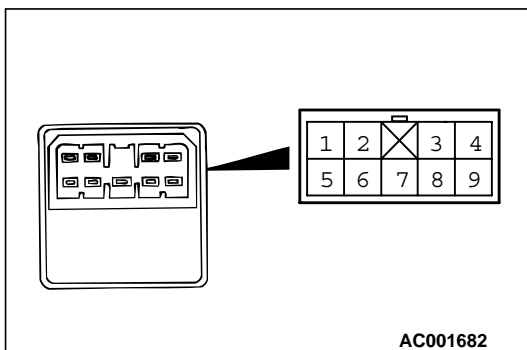

SWITCH POSITION		TESTER CONNECTION	SPECIFIED CONDITION
Left side	Up	4 – 8, 6 – 7	Less than 2 ohm
	Down	4 – 7, 6 – 8	Less than 2 ohm
	Right	3 – 6, 4 – 7	Less than 2 ohm
	Left	3 – 4, 6 – 7	Less than 2 ohm
Right side	Up	2 – 4, 6 – 7	Less than 2 ohm
	Down	2 – 6, 4 – 7	Less than 2 ohm
	Right	4 – 7, 6 – 9	Less than 2 ohm
	Left	4 – 9, 6 – 7	Less than 2 ohm

SPECIFICATIONS**FASTENER TIGHTENING SPECIFICATIONS**

M1511015300149

ITEMS		SPECIFICATIONS
Front bumper	Front turn signal light screw	0.69 ± 0.09 N·m (5.2 ± 0.8 in-lb)
	Front fog light assembly screw	4.9 ± 0.7 N·m (43 ± 6 in-lb)
	Front fog light bracket bolt	4.9 ± 0.7 N·m (43 ± 6 in-lb)
	License plate garish screw	0.9 ± 0.1 N·m (8 ± 1 in-lb)
Windshield wiper and washer	Wiper arm and blade assembly nut	13 ± 3 N·m (113 ± 26 in-lb)
	Wiper motor and wiper link assembly bolt	5.0 ± 0.7 N·m (44 ± 6 in-lb)
	Washer tank motor assembly bolt	12 ± 1 N·m (100 ± 13 in-lb)

SERVICE SPECIFICATIONS

M1511000300121

ITEMS		STANDARD VALUE
Windshield wiper blade position installation mm (in)	Driver's side	33 – 43 (1.3 – 1.7)
	Passenger's side	38 – 48 (1.5 – 1.9)
Rear wiper blade position installation mm (in)		89 – 99 (3.5 – 3.9)

SEALANT AND ADHESIVE

M1511000500136

ITEM	SPECIFICATIONS
Rear pillar garnish	Adhesive tape: Double-sided tape [3 mm (0.1 in) width and 5 mm (0.2 in) thick]