

## GROUP 80B

# SPLICE LOCATIONS

## CONTENTS

|                                   |       |   |        |
|-----------------------------------|-------|---|--------|
| HOW TO READ SPLICE LOCATIONS..... | 80B-2 | FLOOR AND ROOF <ECLIPSE>.....                       | 80B-9  |
| INDEX.....                        | 80B-3 | FLOOR AND WINDSHIELD APERTURE <ECLIPSE SPYDER>..... | 80B-10 |
| ENGINE COMPARTMENT.....           | 80B-4 | DOOR.....   | 80B-11 |
| ENGINE AND TRANSAXLE.....         | 80B-5 | LUGGAGE COMPARTMENT <ECLIPSE>.....                  | 80B-12 |
| DASH PANEL.....                   | 80B-6 | LUGGAGE COMPARTMENT <ECLIPSE SPYDER>.....           | 80B-13 |

# HOW TO READ SPLICE LOCATIONS

M1802000100108

"Splice locations" describes splice points of each wiring harness on an actual vehicle.

Indicates a splice point number.  
The splice point numbers are identical to those in "CIRCUIT DIAGRAMS," making them easy to use.  
In addition, the splice point numbers are usually numbered clockwise.

Example: S 013

Sequential number

Prefix meaning splice point

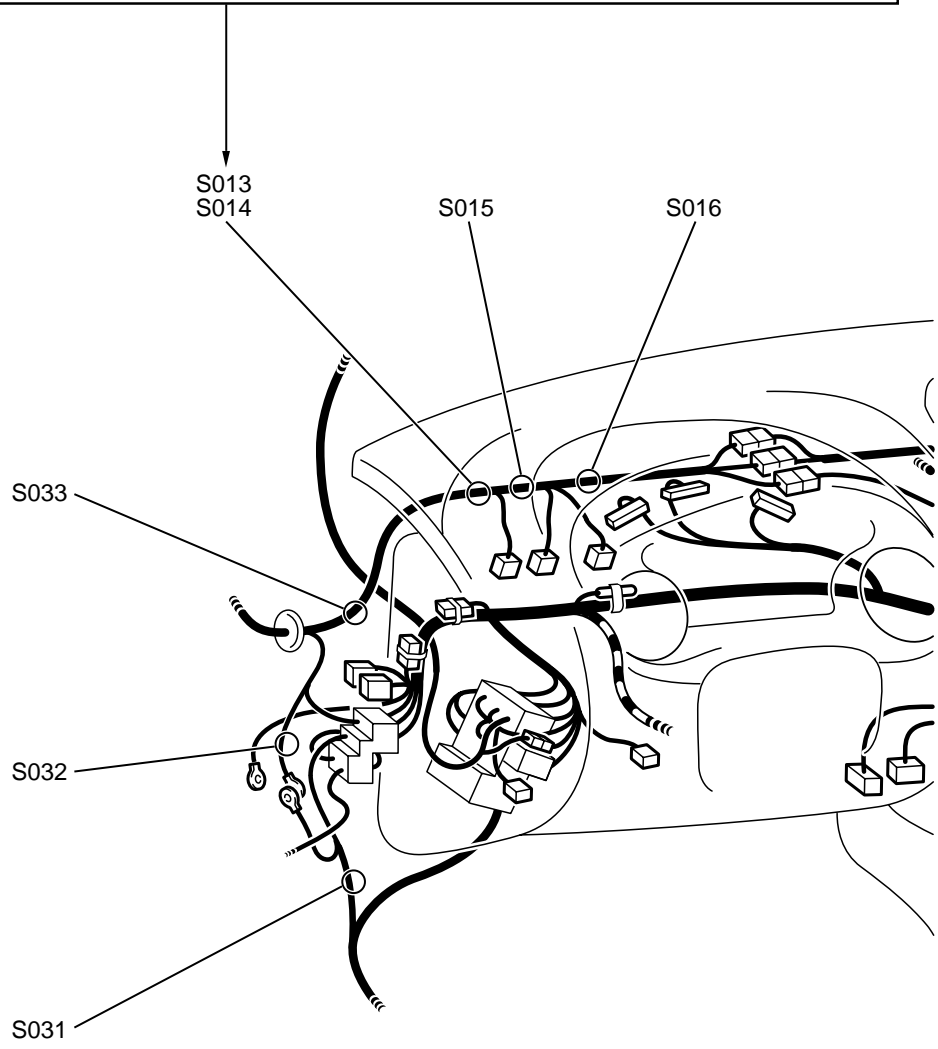

AC003587 AB

TSB Revision

# INDEX

M1802000900104

This index shows the page numbers where the splice locations are.

| <b>SPLICE LOCATION NO.</b> | <b>PAGE</b> | <b>SPLICE LOCATION NO.</b> | <b>PAGE</b> | <b>SPLICE LOCATION NO.</b> | <b>PAGE</b> | <b>SPLICE LOCATION NO.</b> | <b>PAGE</b> |
|----------------------------|-------------|----------------------------|-------------|----------------------------|-------------|----------------------------|-------------|
| S001                       | P.80B-4     | S031                       | P.80B-5     | S061                       | P.80B-6     | S091                       | P.80B-6     |
| S002                       | P.80B-5     | S032                       | P.80B-5     | S062                       | P.80B-6     | S092                       | P.80B-6     |
| S003                       | P.80B-5     | S033                       | P.80B-5     | S063                       | P.80B-6     | S093                       | P.80B-9     |
| S004                       | P.80B-5     | S034                       | P.80B-5     | S064                       | P.80B-6     | S094                       | P.80B-9     |
| S005                       | P.80B-5     | S035                       | P.80B-5     | S065                       | P.80B-6     | S095                       | P.80B-9     |
| S006                       | P.80B-5     | S036                       | P.80B-5     | S066                       | P.80B-6     | S096                       | P.80B-10    |
| S007                       | P.80B-5     | S037                       | P.80B-5     | S067                       | P.80B-6     | S097                       | P.80B-10    |
| S008                       | P.80B-5     | S038                       | P.80B-6     | S068                       | P.80B-6     | S098                       | P.80B-10    |
| S009                       | P.80B-5     | S039                       | P.80B-6     | S069                       | P.80B-6     | S099                       | P.80B-10    |
| S010                       | P.80B-5     | S040                       | P.80B-6     | S070                       | P.80B-6     | S100                       | P.80B-11    |
| S011                       | P.80B-5     | S041                       | P.80B-6     | S071                       | P.80B-6     | S101                       | P.80B-12    |
| S012                       | P.80B-5     | S042                       | P.80B-6     | S072                       | P.80B-6     | S102                       | P.80B-12    |
| S013                       | P.80B-5     | S043                       | P.80B-6     | S073                       | P.80B-6     | S103                       | P.80B-12    |
| S014                       | P.80B-5     | S044                       | P.80B-6     | S074                       | P.80B-6     | S104                       | P.80B-12    |
| S015                       | P.80B-5     | S045                       | P.80B-6     | S075                       | P.80B-6     | S105                       | P.80B-12    |
| S016                       | P.80B-5     | S046                       | P.80B-6     | S076                       | P.80B-6     | S106                       | P.80B-12    |
| S017                       | P.80B-5     | S047                       | P.80B-6     | S077                       | P.80B-6     | S107                       | P.80B-12    |
| S018                       | P.80B-5     | S048                       | P.80B-6     | S078                       | P.80B-6     | S108                       | P.80B-12    |
| S019                       | P.80B-5     | S049                       | P.80B-6     | S079                       | P.80B-6     | S109                       | P.80B-12    |
| S020                       | P.80B-5     | S050                       | P.80B-6     | S080                       | P.80B-6     | S110                       | P.80B-12    |
| S021                       | P.80B-5     | S051                       | P.80B-6     | S081                       | P.80B-6     | S111                       | P.80B-12    |
| S022                       | P.80B-5     | S052                       | P.80B-6     | S082                       | P.80B-6     | S112                       | P.80B-12    |
| S023                       | P.80B-5     | S053                       | P.80B-6     | S083                       | P.80B-6     | S113                       | P.80B-13    |
| S024                       | P.80B-5     | S054                       | P.80B-6     | S084                       | P.80B-6     | S114                       | P.80B-13    |
| S025                       | P.80B-5     | S055                       | P.80B-6     | S085                       | P.80B-6     | S115                       | P.80B-13    |
| S026                       | P.80B-5     | S056                       | P.80B-6     | S086                       | P.80B-6     | S116                       | P.80B-13    |
| S027                       | P.80B-5     | S057                       | P.80B-6     | S087                       | P.80B-6     | S117                       | P.80B-13    |
| S028                       | P.80B-5     | S058                       | P.80B-6     | S088                       | P.80B-6     | S118                       | P.80B-9,    |
| S029                       | P.80B-5     | S059                       | P.80B-6     | S089                       | P.80B-6     |                            | P.80B-10    |
| S030                       | P.80B-5     | S060                       | P.80B-6     | S090                       | P.80B-6     |                            |             |

# ENGINE COMPARTMENT

M1802000200097

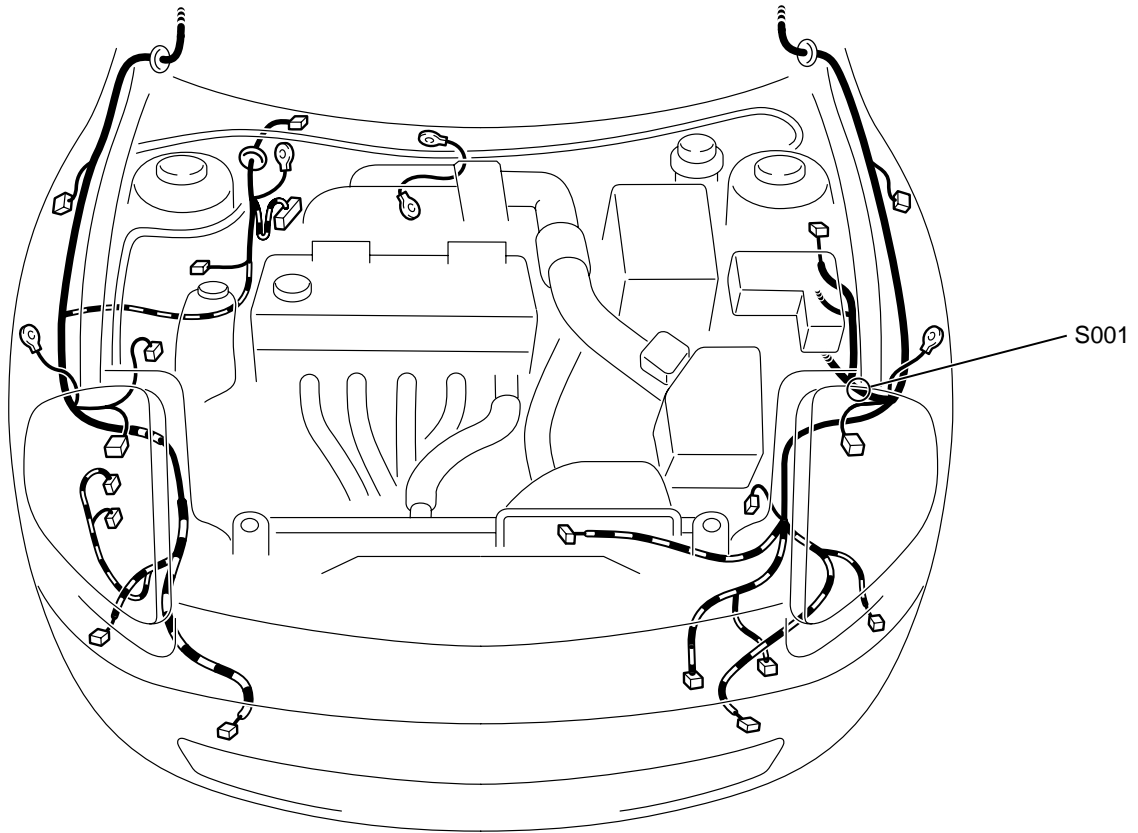

AC003588AB

TSB Revision

# ENGINE AND TRANSAXLE

M1802001400049

## 2.4L ENGINE

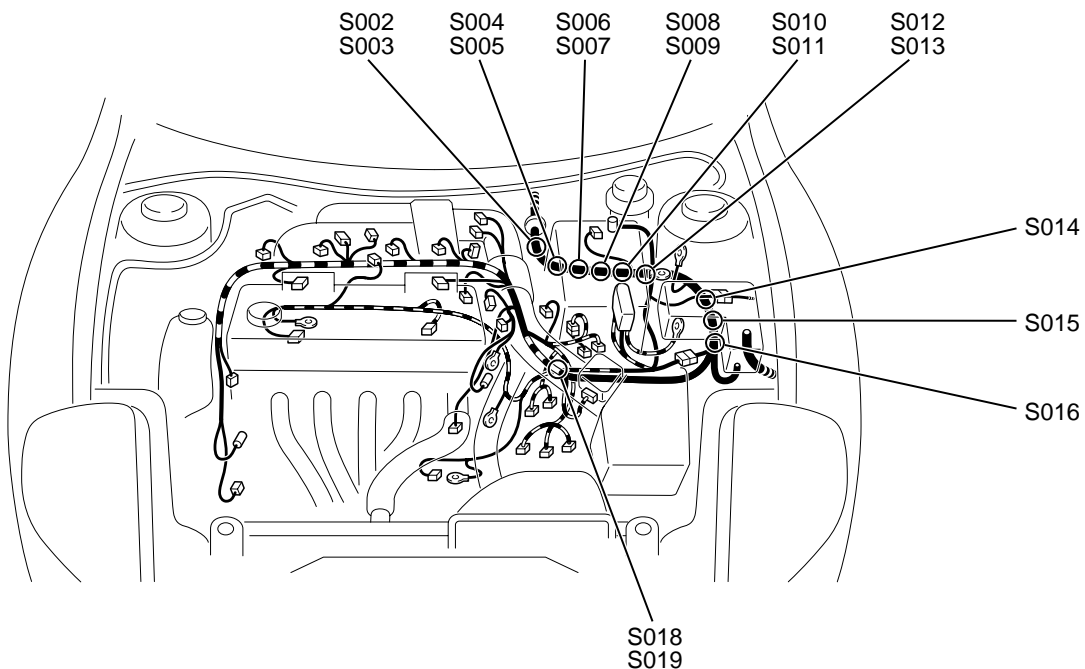

## 3.0L ENGINE

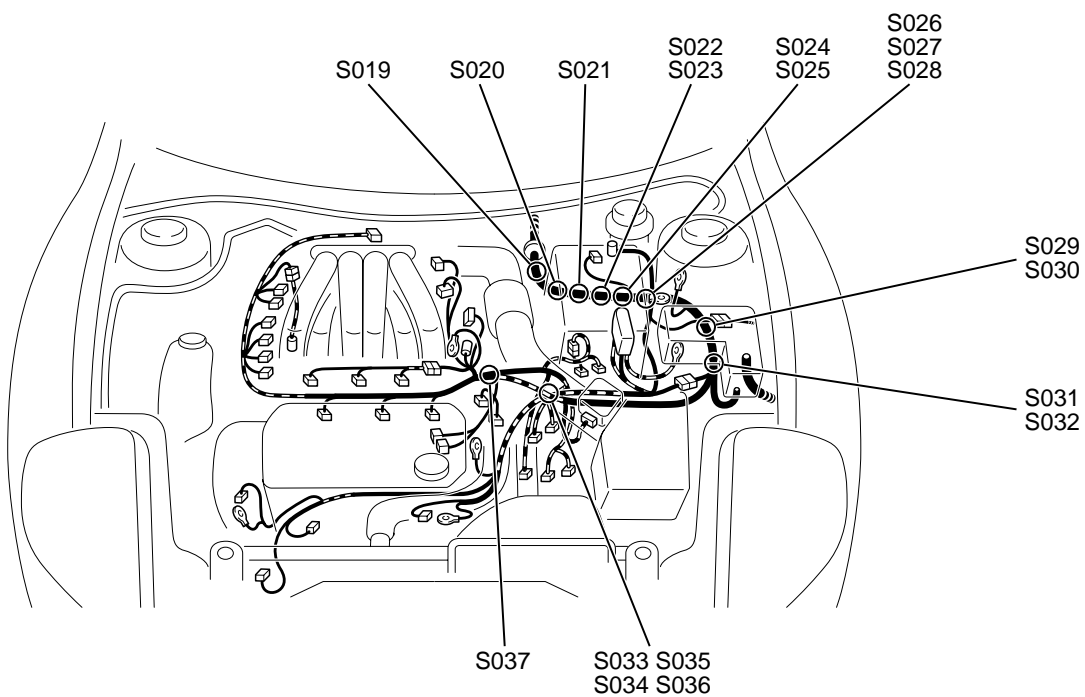

AC003589AB

TSB Revision

# DASH PANEL

M1802000300094

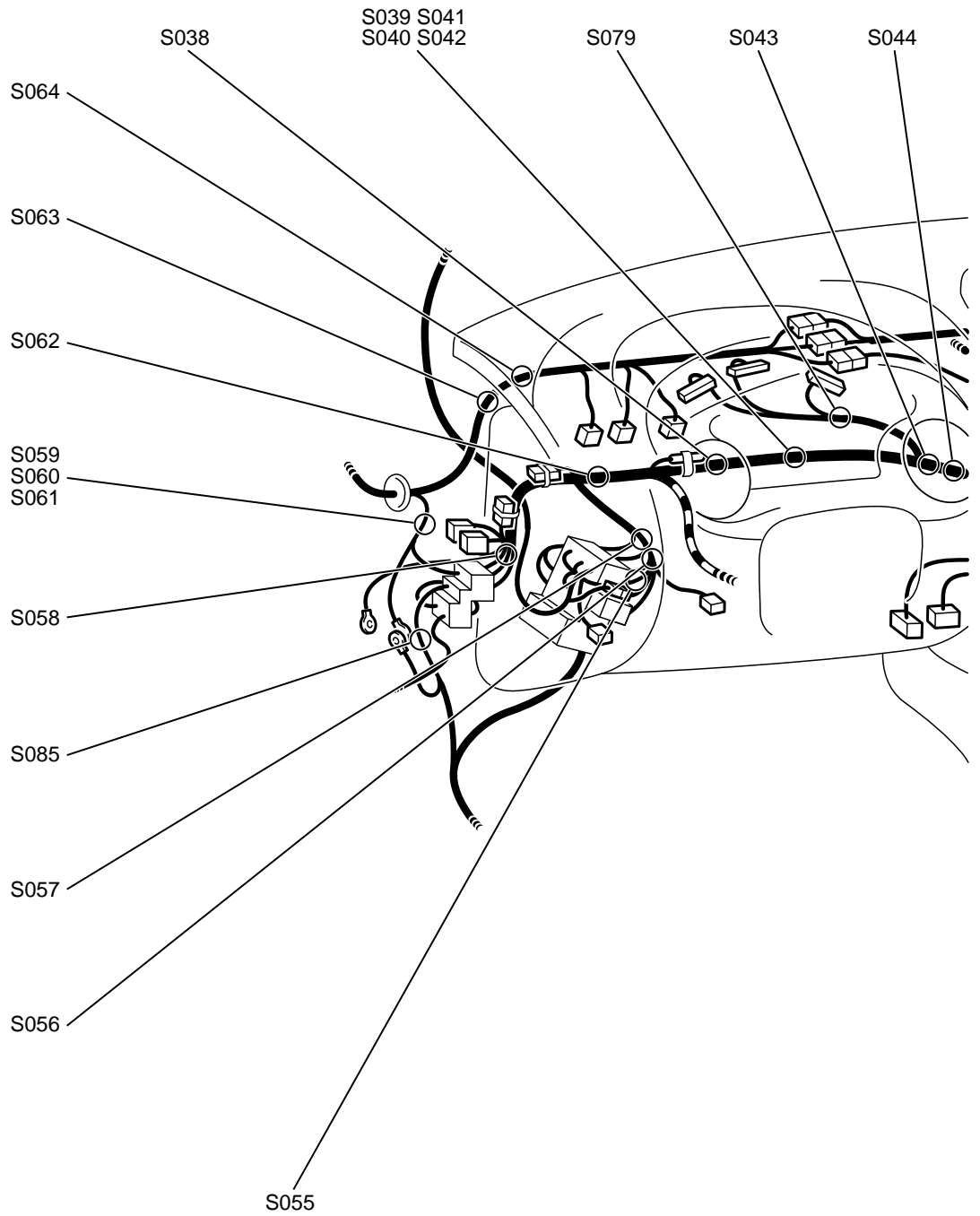

AC003590AB

TSB Revision

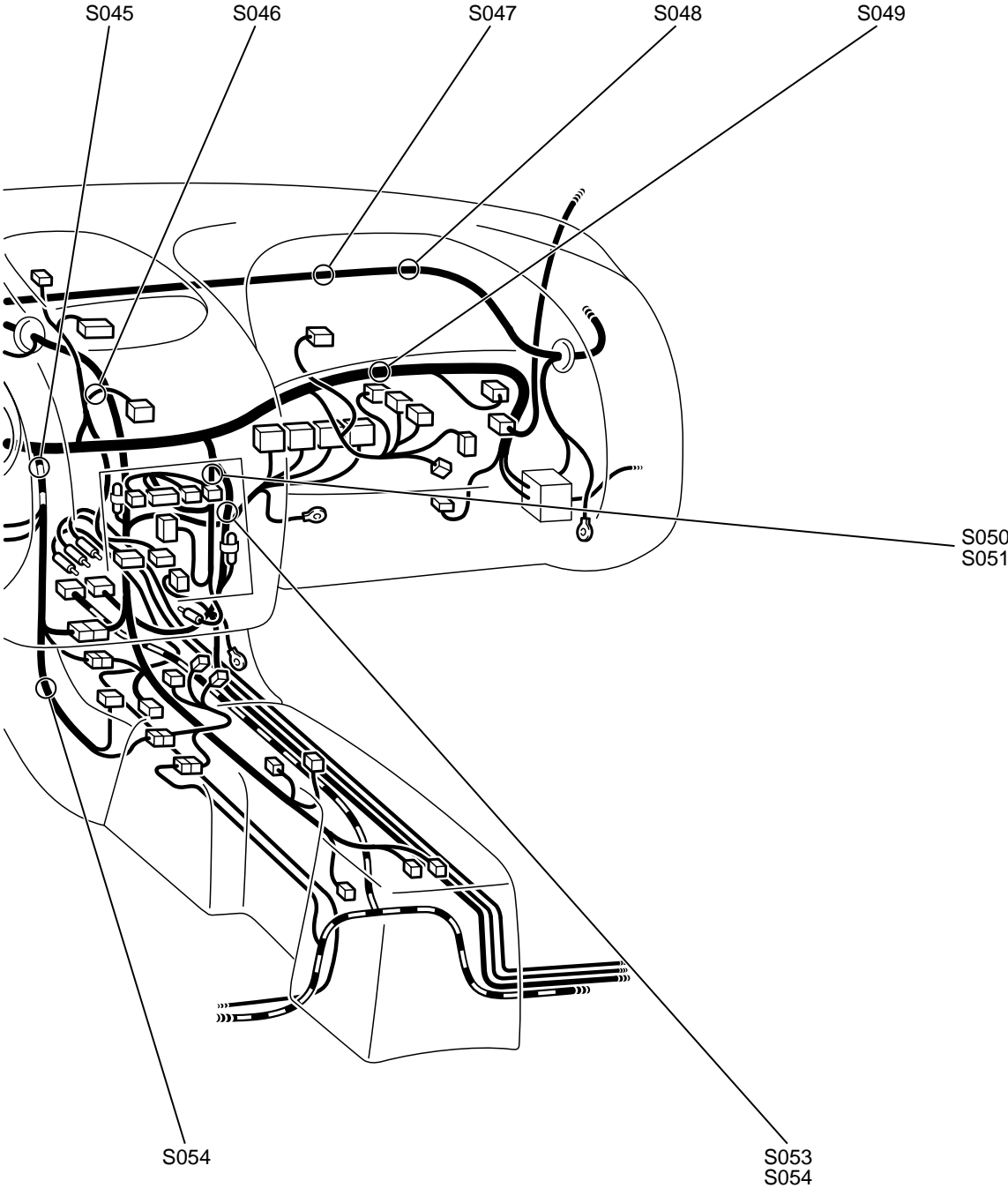

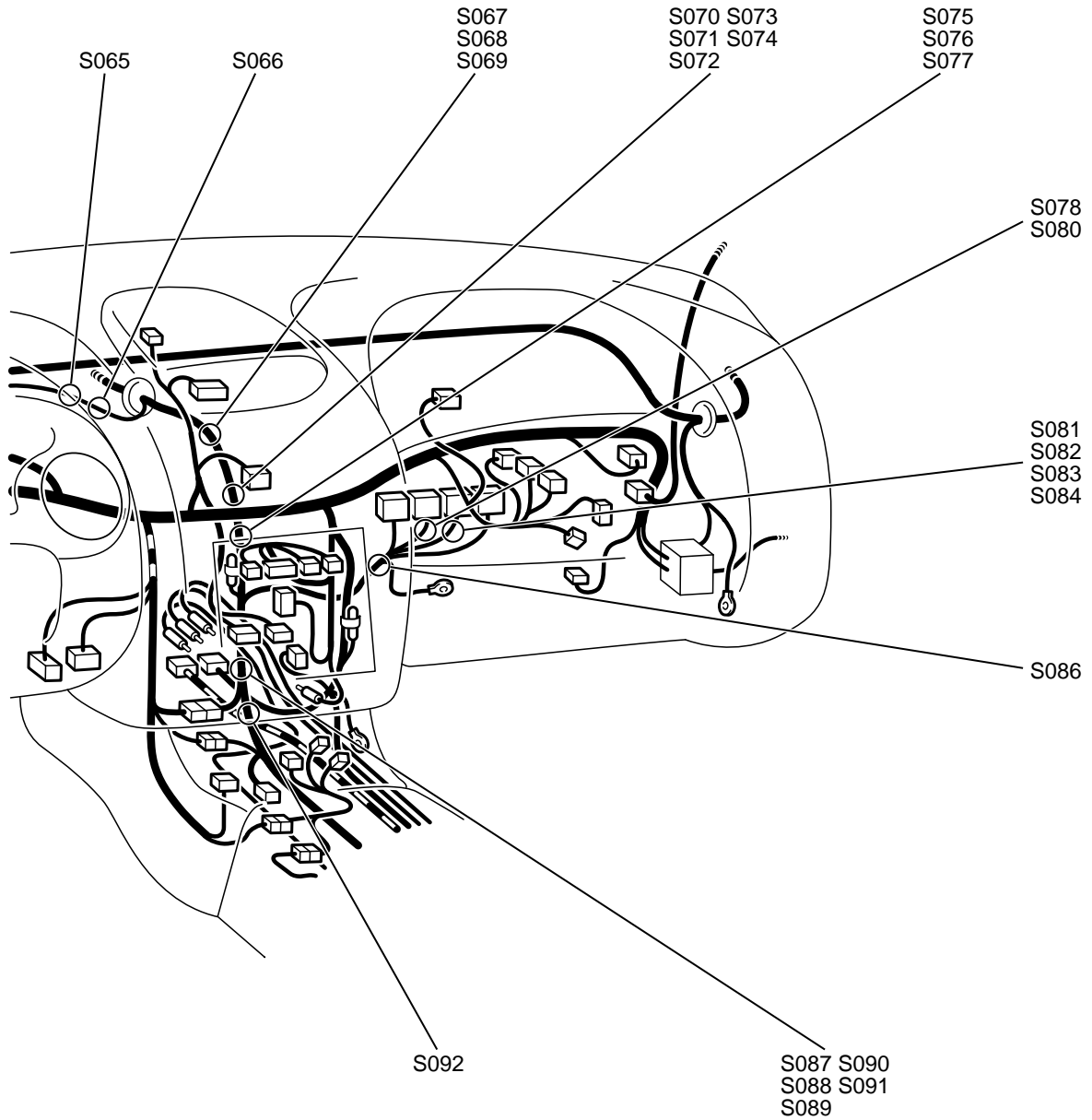

AC003592 AB

TSB Revision



FLOOR AND ROOF <ECLIPSE>

M1802001200067

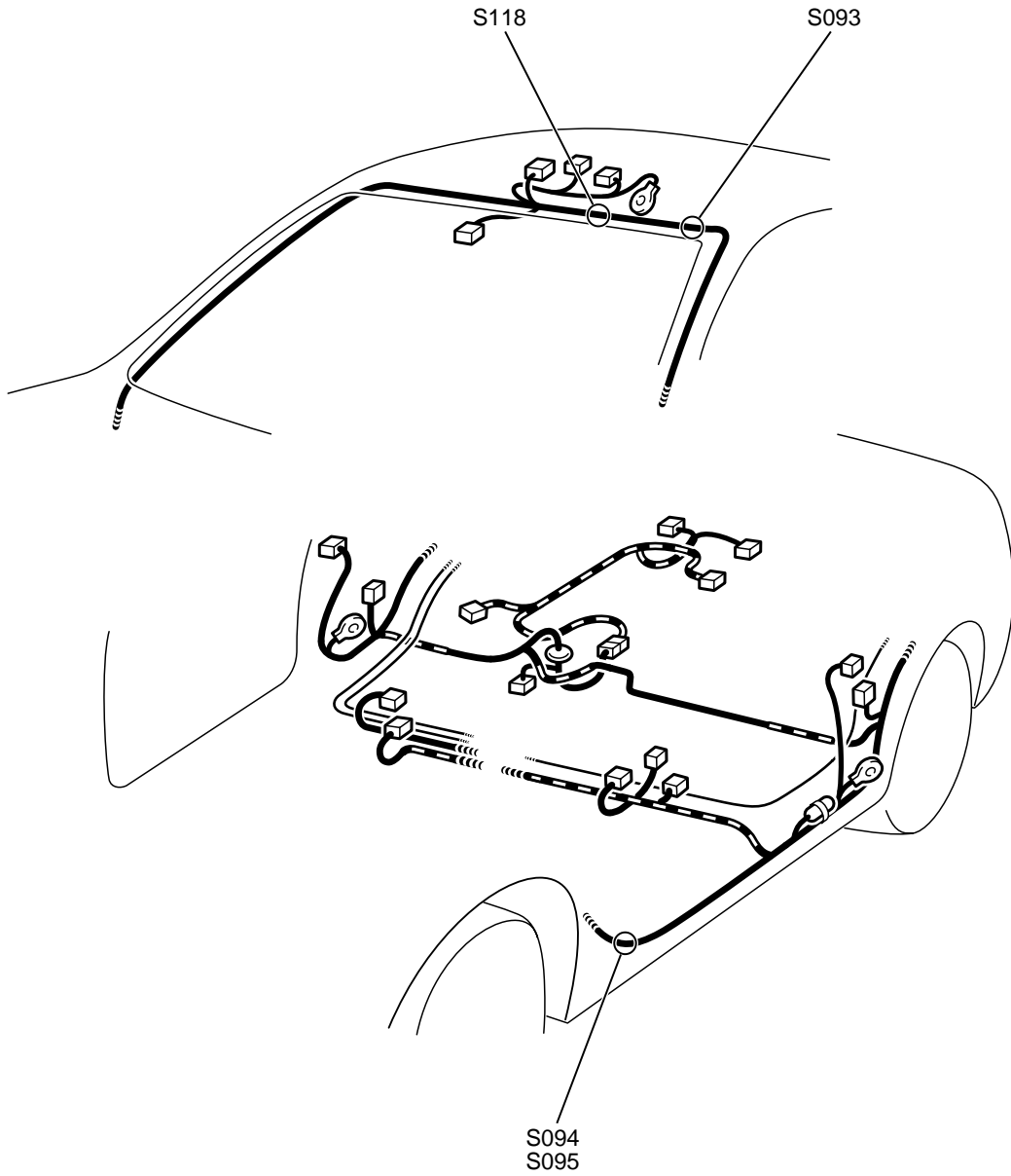

AC003593AB

TSB Revision

FLOOR AND WINDSHIELD APERTURE  
<ECLIPSE SPYDER>

M1802001200078

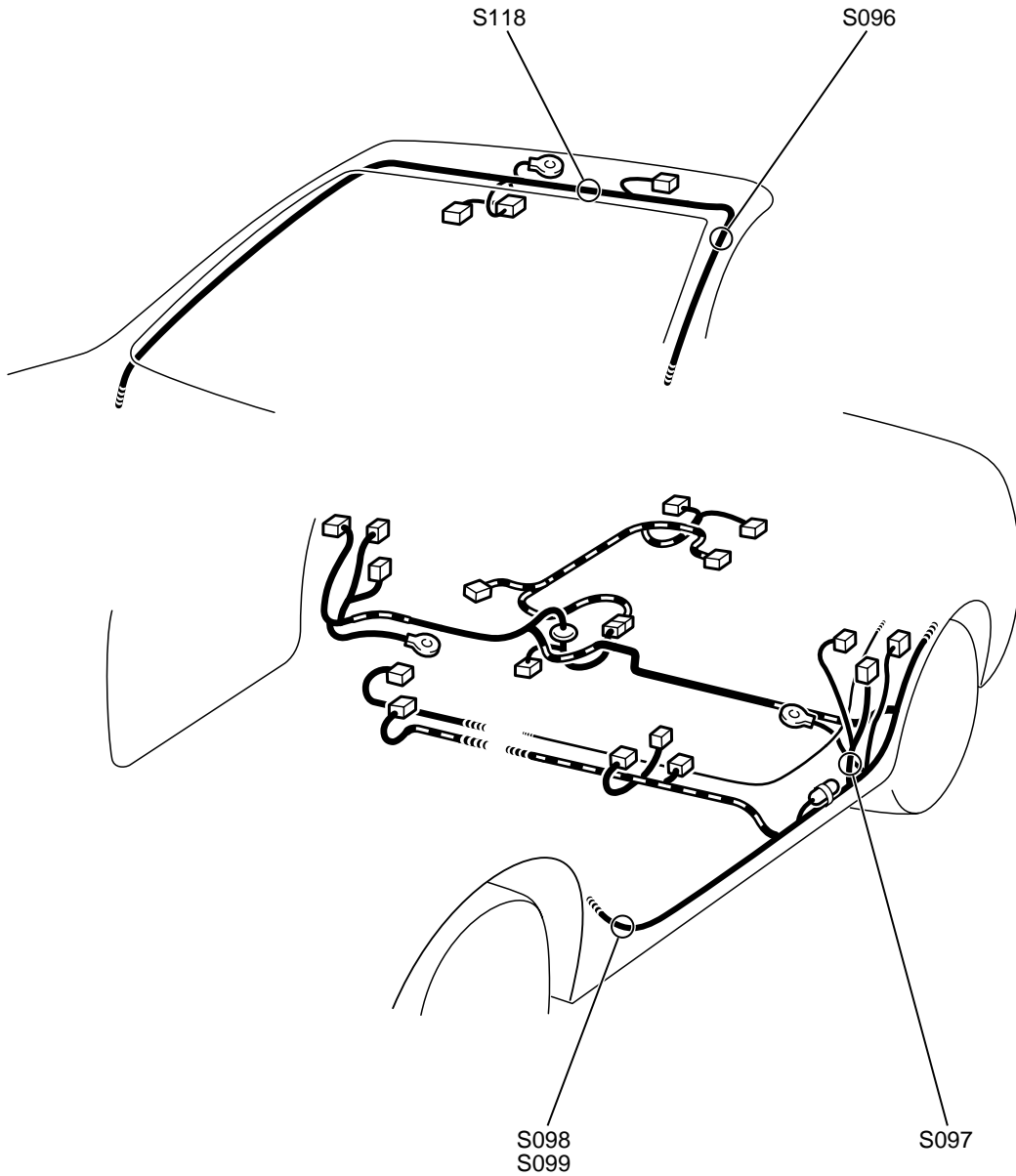

AC003594AB

DOOR

M1802000800099

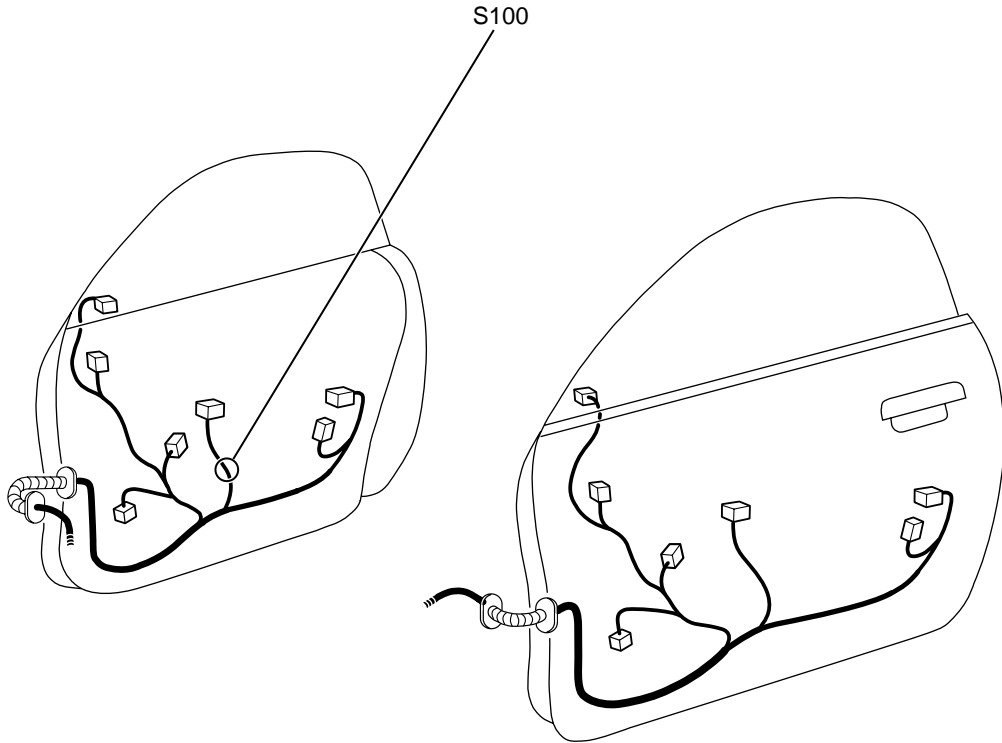

AC003595 AB

TSB Revision

LUGGAGE COMPARTMENT <ECLIPSE>

M1802000700025

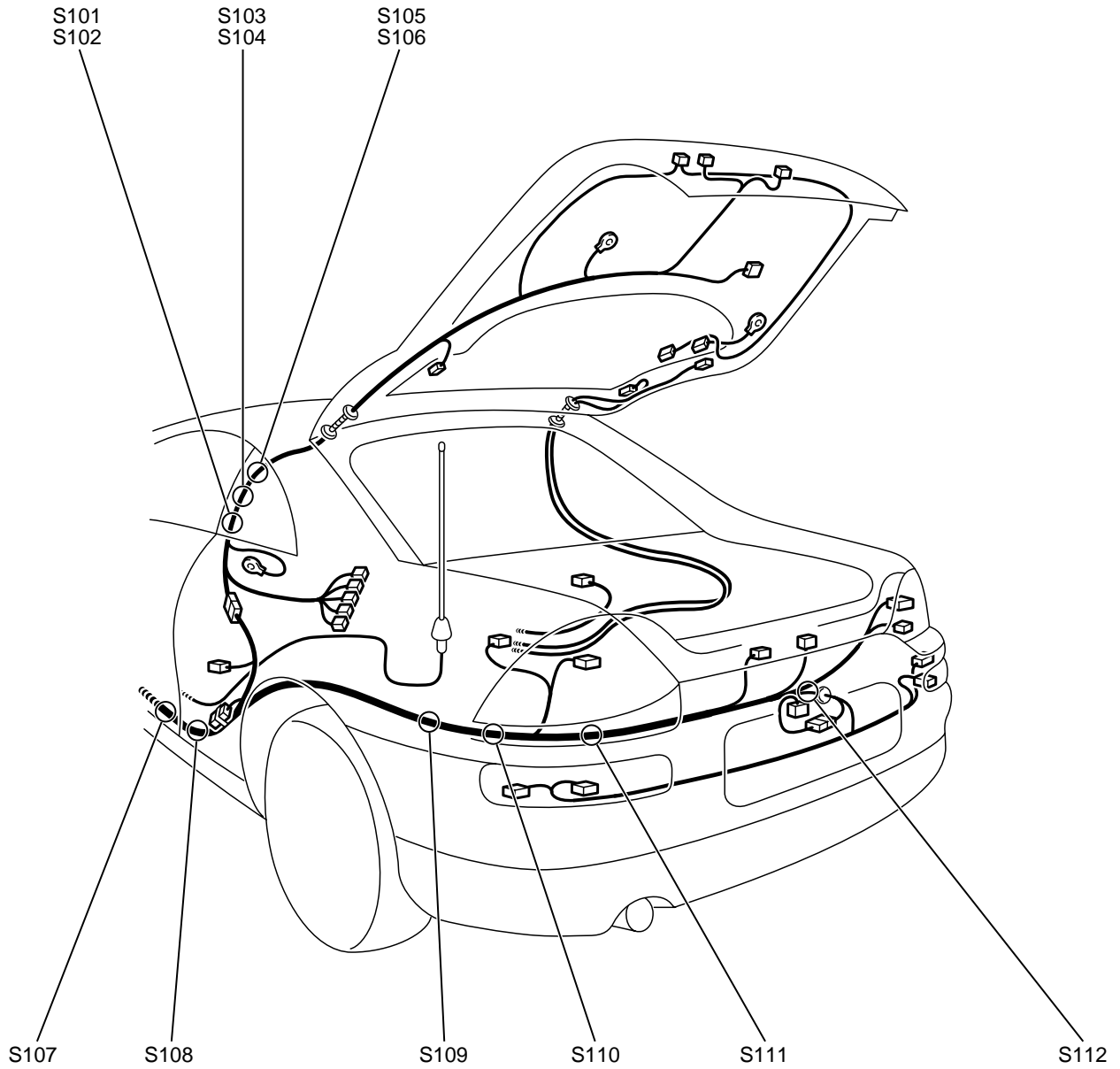

AC003596AB

TSB Revision

LUGGAGE COMPARTMENT <ECLIPSE SPYDER>

M1802000700036

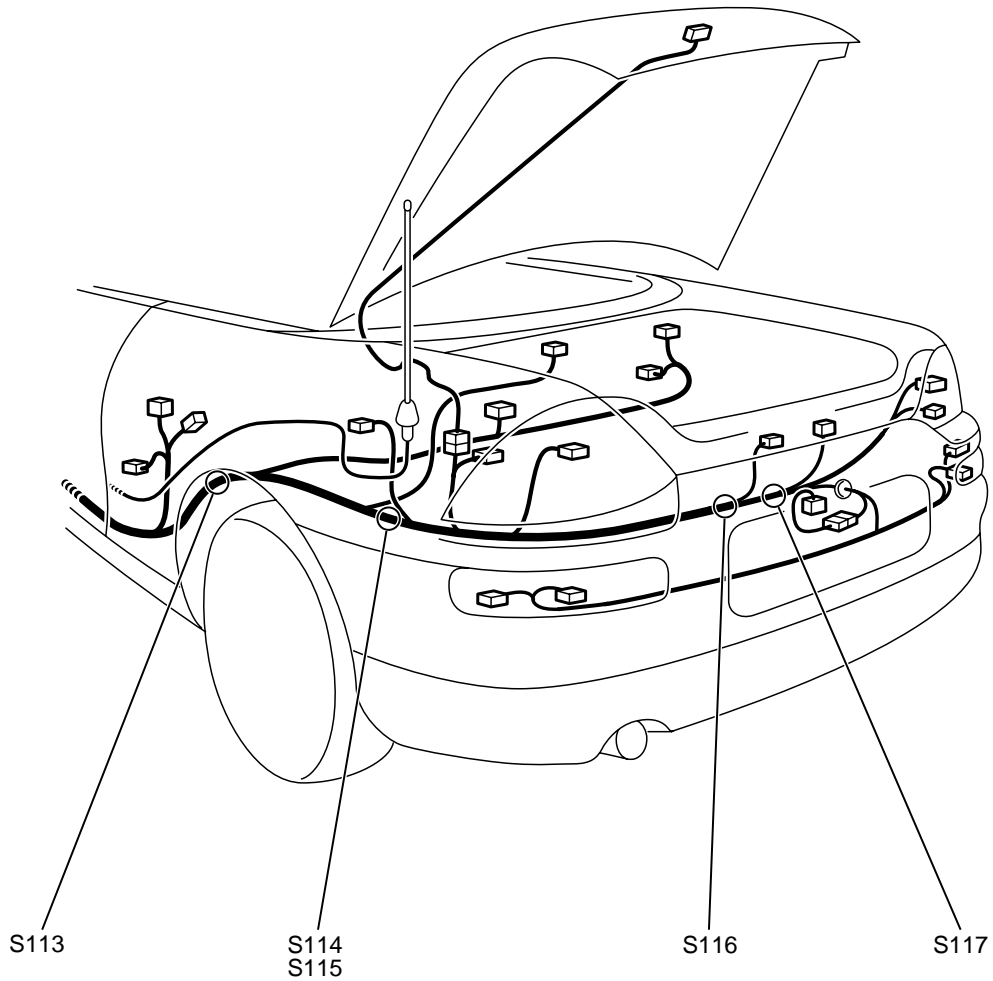

AC003597AB

TSB Revision

---

## NOTES