GROUP 33

**FRONT
SUSPENSION**

CONTENTS

GENERAL DESCRIPTION..... 33-2

GENERAL DESCRIPTION

M2330000100534

Front suspension is McPherson Strut type with flat shaped stamped-steel cross member, which has high rigidity for handling stability improvement.

FEATURES

STRUTS

Increased the rigidity by adopting bigger cylinder size for 3.8L, and optimizing the damping force settings.

LOWER ARM ASSEMBLY

Improved handling, stability, and ride comfort by improved rear side bushings.

STABILIZER

Reduced weight by attaching stabilizer to the strut for better efficiency. Also improve the response by adopting the ball joint type linkage.

CROSSMEMBER

Improved the rigidity of suspension member attaching point and reduced weight by adopting the flat shaped stamped-steel crossmember.

STRUT INSULATOR

Improved noise isolation by adopting the load separation type strut insulator, which separates input of damping force through strut rod from road vibration.

CONSTRUCTION DIAGRAM

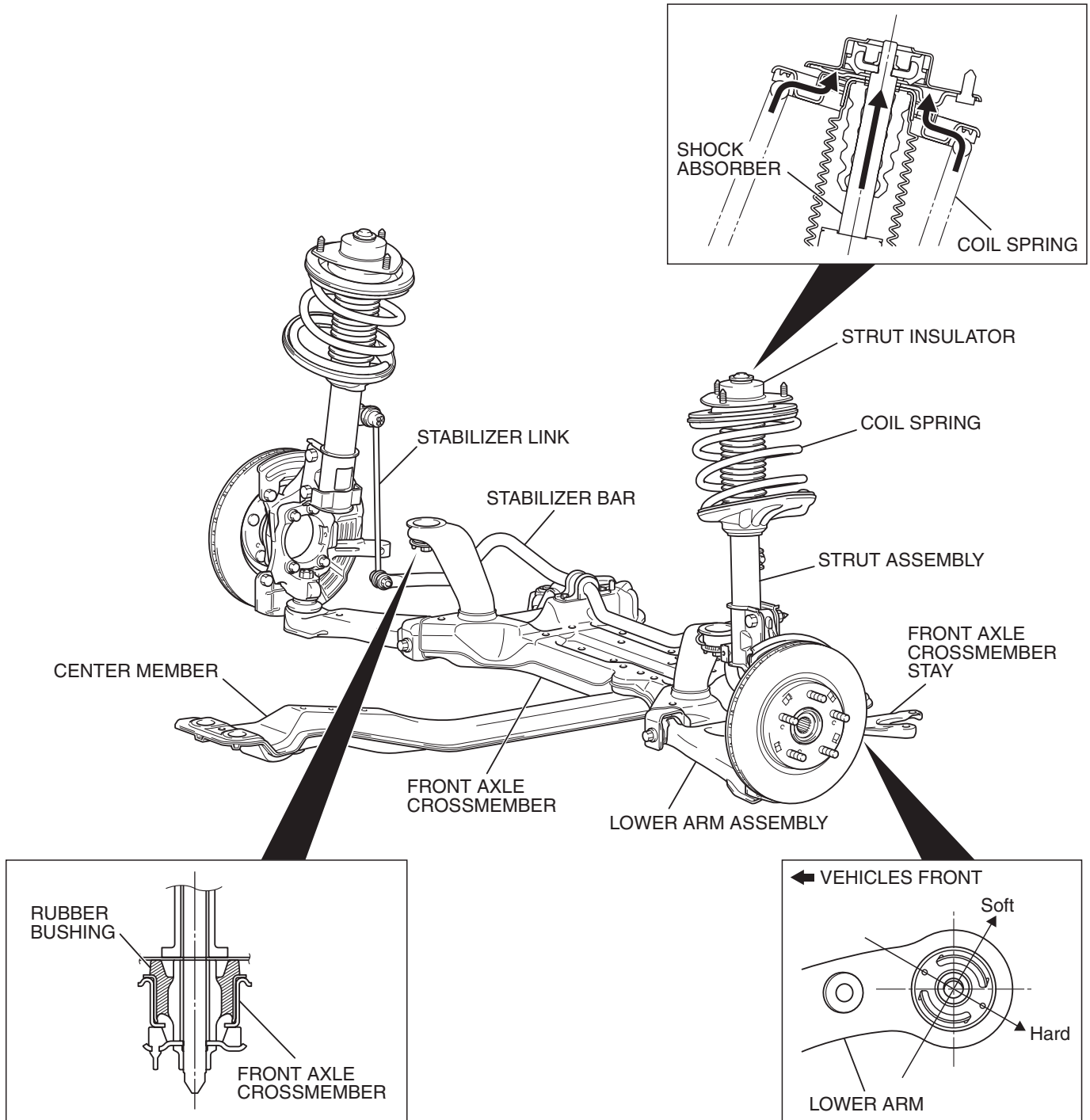

AC406763AB

SPECIFICATIONS**SUSPENSION SYSTEM**

ITEM	SPECIFICATION
Suspension method	McPherson strut with coil spring

WHEEL ALIGNMENT

ITEM	SPECIFICATION
Camber	0°00'
Caster	3°00'
Kingpin inclination	12°54'
Toe-in mm (in)	0 (0)

COIL SPRING

ITEM	2.4L ENGINE	3.8L ENGINE
Wire diameter mm (in)	15.2 (0.60)	15.7 (0.62)
Average diameter mm (in)	170 – 180 (6.7 – 7.1)	170 – 180 (6.7 – 7.1)
Free length mm (in)	310 (12.20)	310 (12.20)