

---

**GROUP 26**

**FRONT AXLE**

**CONTENTS**

**GENERAL DESCRIPTION..... 26-2**

**GENERAL DESCRIPTION**

M2260000100422

The front axle consists of front hub unit bearings, knuckles and drive shafts, and it has the following features:

- The wheel bearing incorporates a unit ball bearing (double-row angular contact ball bearing) for reduced friction.
- The front wheel hub assembly combines the hub, wheel bearing, and oil seal in a single unit for fewer parts, better durability, improved assembly precision, and better structural organization.
- The drive shaft incorporates BJ-TJ type constant velocity joints <2.4L engine> and EBJ-PTJ type constant velocity joints <3.8L engine> with high transmission efficiency for low vibration and noise.

- Due to the use of the inner shaft and bracket assembly, the right and left drive shafts are approximately the same in length. This reduces noise, vibration and torque steer.<3.8L-RH>
- The dynamic damper is mounted on the LH drive shaft <all models> and on the RH drive shaft <2.4L engine> to reduce differential gear noise.
- ABS rotor for detecting the wheel speed is press-fitted to the BJ <2.4L engine> and EBJ <3.8L engine>.

BJ: Birfield Joint

TJ: Tripod joint

EBJ (Eight Ball Fixed Joint): The use of the smaller size eight balls inside the joint achieves weight saving and compact size compared with BJ.

PTJ: Pillow Tripod Joint

**SPECIFICATIONS**

ITEM			2.4L ENGINE	3.8L ENGINE	
				A/T	M/T
Wheel bearing	Type		Unit ball bearing (Double-row angular contact ball bearing)		
Drive shaft	Joint type	Outer	BJ	EBJ	EBJ
		Inner	TJ	PTJ	PTJ
	Length (joint to joint) mm (in)	Left	420 (16.5)	399.2 (15.7)	385.5 (15.2)
		Right	742 (29.2)	416.9 (16.4)	426.8 (16.8)

*NOTE: The wheel bearing is part of the hub, therefore its size is not listed here.*

CONSTRUCTION DIAGRAM

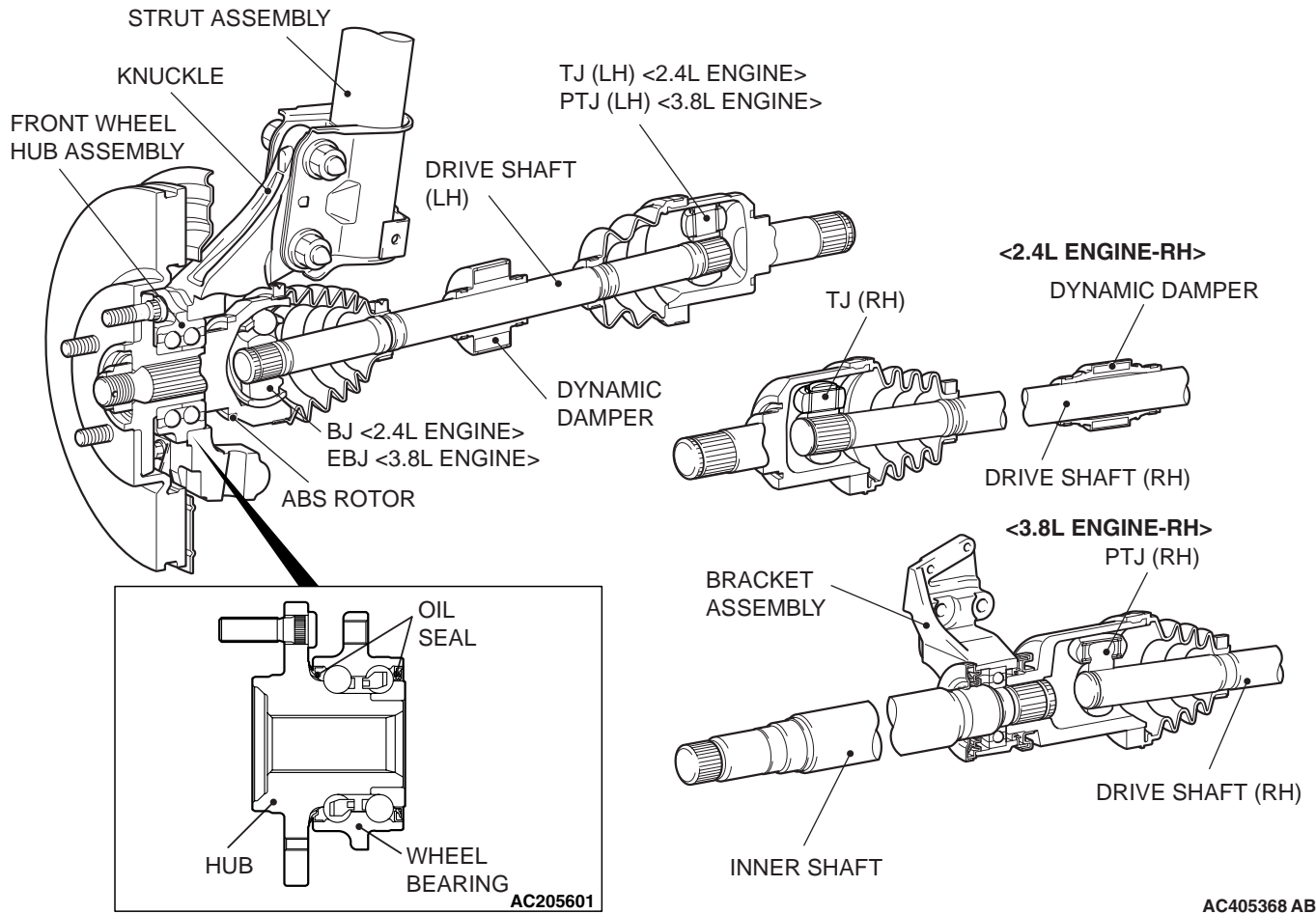

---

## NOTES