

---

**GROUP 32**

**POWER PLANT  
MOUNT**

**CONTENTS**

**GENERAL DESCRIPTION..... 32-2**

**GENERAL DESCRIPTION**

M2320000100395

The inertia axial system is used for the engine mount system.

- The engine front mounting bracket is a dome-shaped fluid-filled mount. This mount reduces vibration, improves riding comfort, and enhances vehicle stability on rough roads.

**CONSTRUCTION DIAGRAM****<2.4L ENGINE>**

AC305857

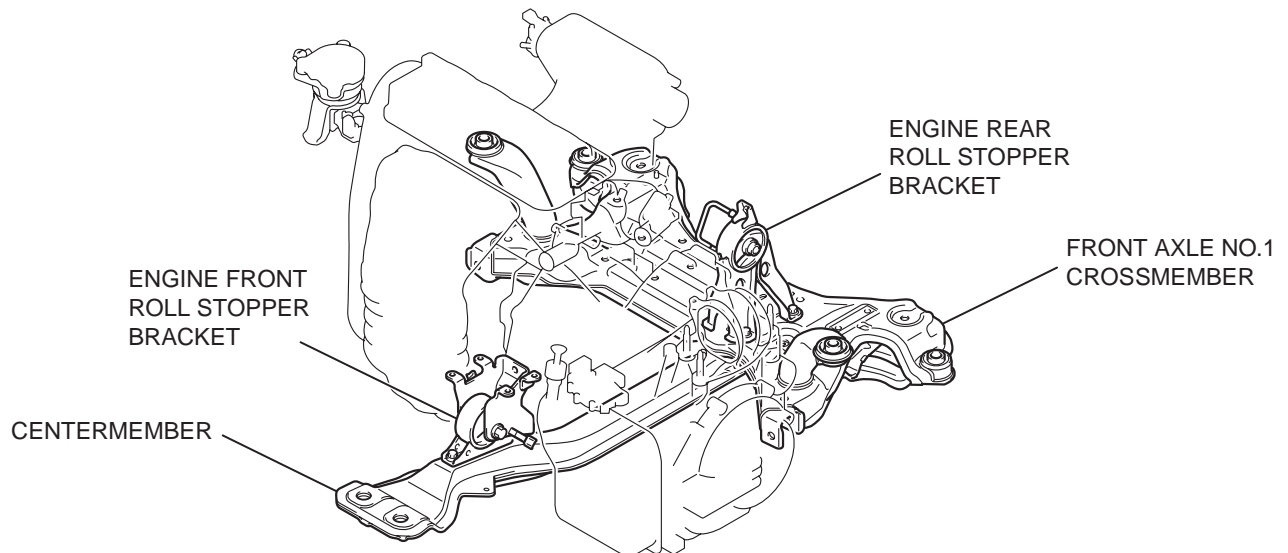
AC305858  
AC305859AB

<3.8L ENGINE>

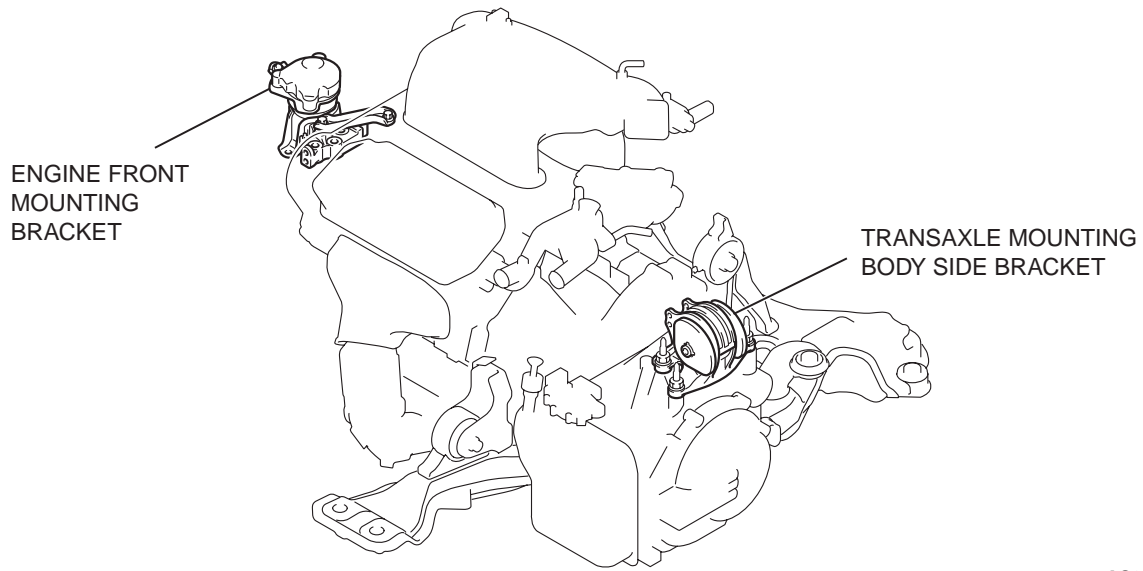

AC305860

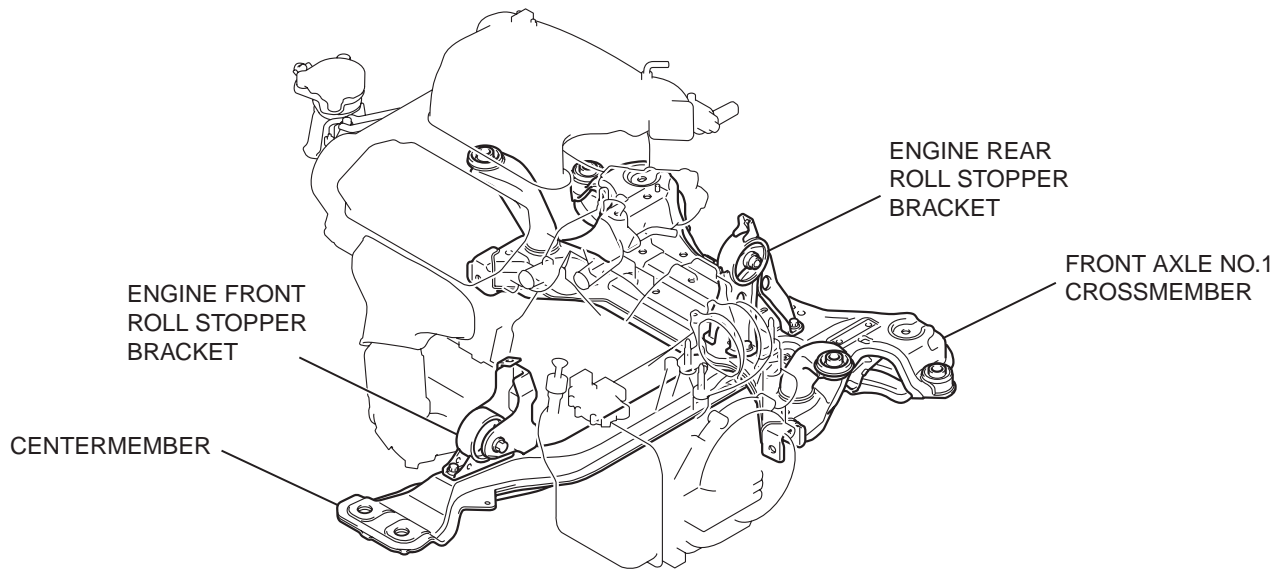

AC305861  
AC406893AB

---

## NOTES